

Mexico 60220

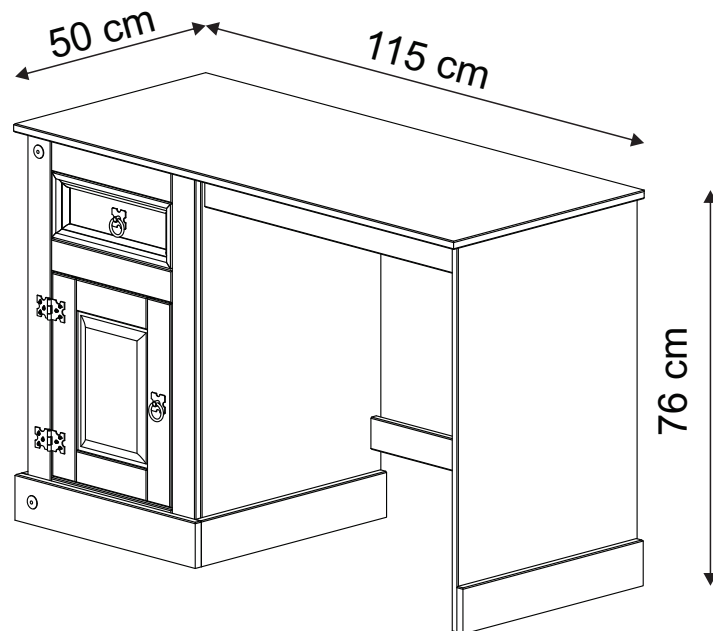

D Montageanleitung
60220

FR Notice de montage
60220

NL Handleiding voor de montage
60220

CZ Montážní návod
60220

HU Szerelési útmutató
60220

TR Montaj talimatı
60220

GB Assembly instructions
60220

IT Istruzioni di montaggio
60220

PL Instrukcja montażu
60220

SK Návod na montáž
60220

RO Instrucțiuni de montaj
60220

RU Инструкция по монтажу
60220

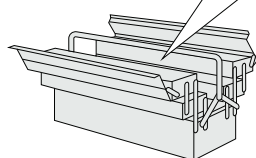
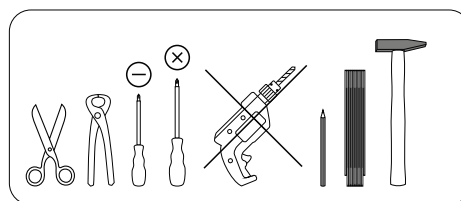
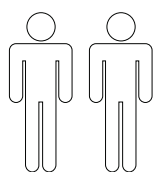

0
10
20
30
40
50
60
70
80
90
100
110
120
130
140
150
160
170
180
190
200

Service • Assistenza • Dienstverlening • Serwis Servis • Szerviz • Сервисная служба	
Name • Nom • Nome • Naam • Nazwa • Jméno • Názov • Név • Denumire • Isim • Название	
Nr. • No. • N° • Номер • Č • Sz	
Typ • Type • Tip • Típus • Tipo • Тип	

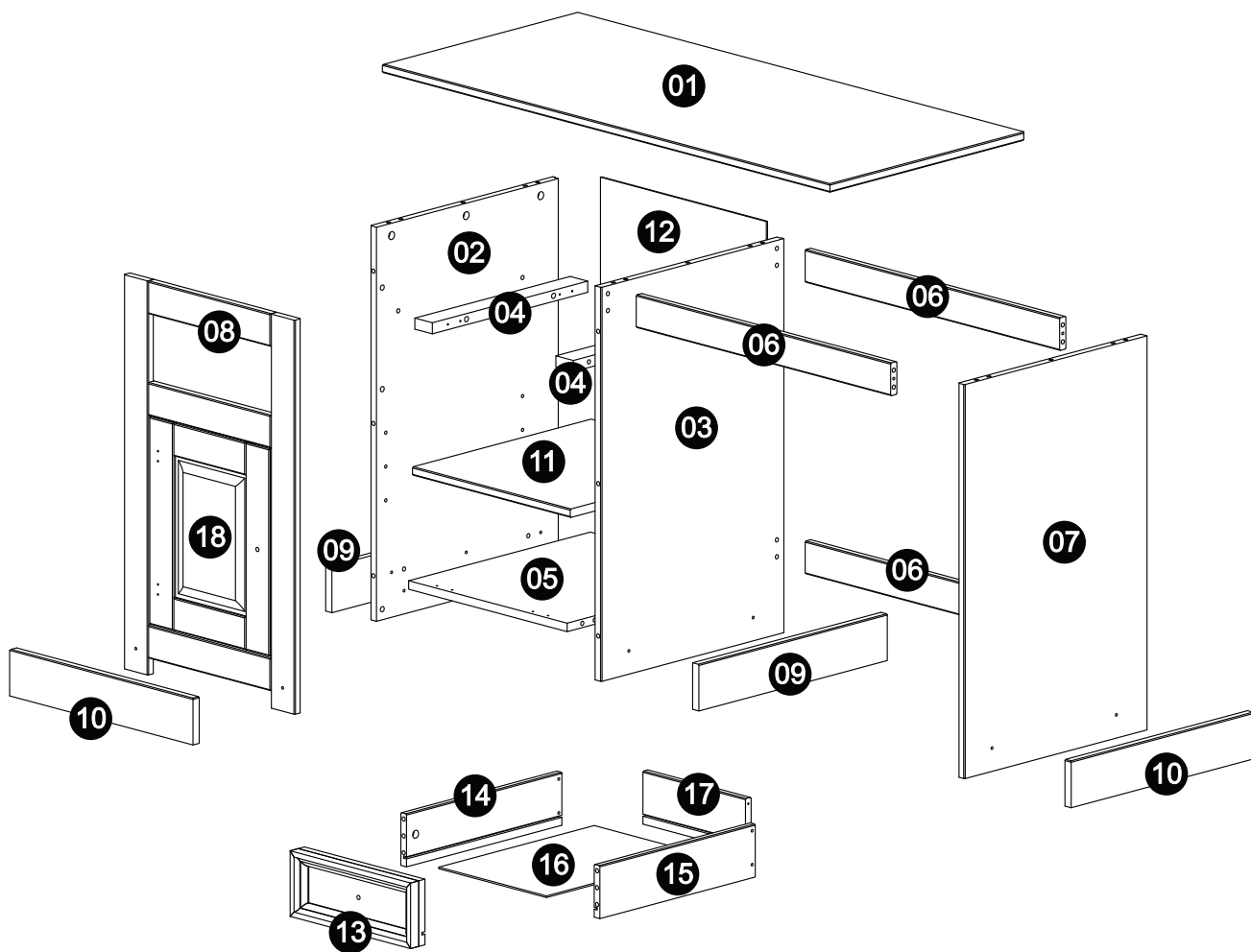

A 8,0x30 36x	B 4,0x30 17x	C 4,0x25 4x	D 8x8 6x	E 3,5x14 1x	F 3,5x14 14x	G 4,0x40 4x	H 400 1x	I 400 1x
J 17x	K 4,0x30 10x	L 4,0x25 14x	M 8x8 20x	N 2x	O 2x	P 3/16"x5/8" 2x	Q 1x	R 2x
S 3,0x12 12x	T 2x							

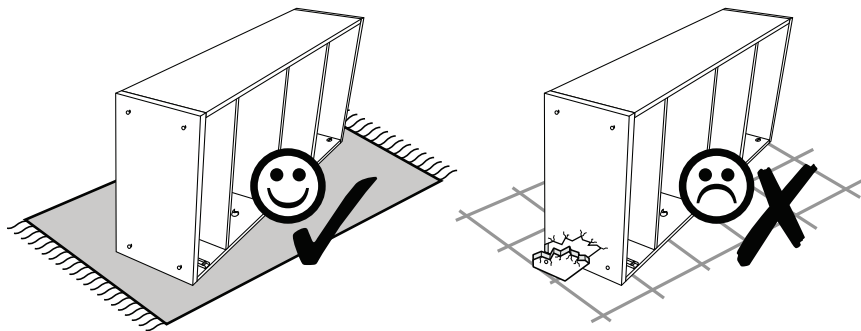

1

- | | | | | | | | | | | | |
|----------|---------------|----------|-----|----------|----|----------|----|----------|----|----------|--------------|
| A | 8,0x30
36x | B | 17x | C | 4x | D | 6x | E | 1x | F | 3,5x14
2x |
|----------|---------------|----------|-----|----------|----|----------|----|----------|----|----------|--------------|

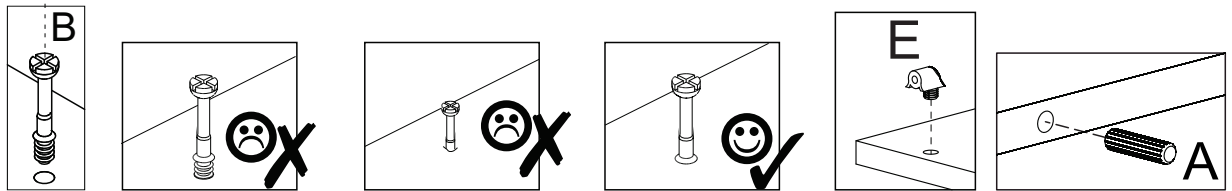
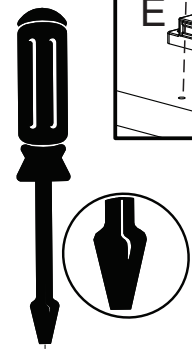
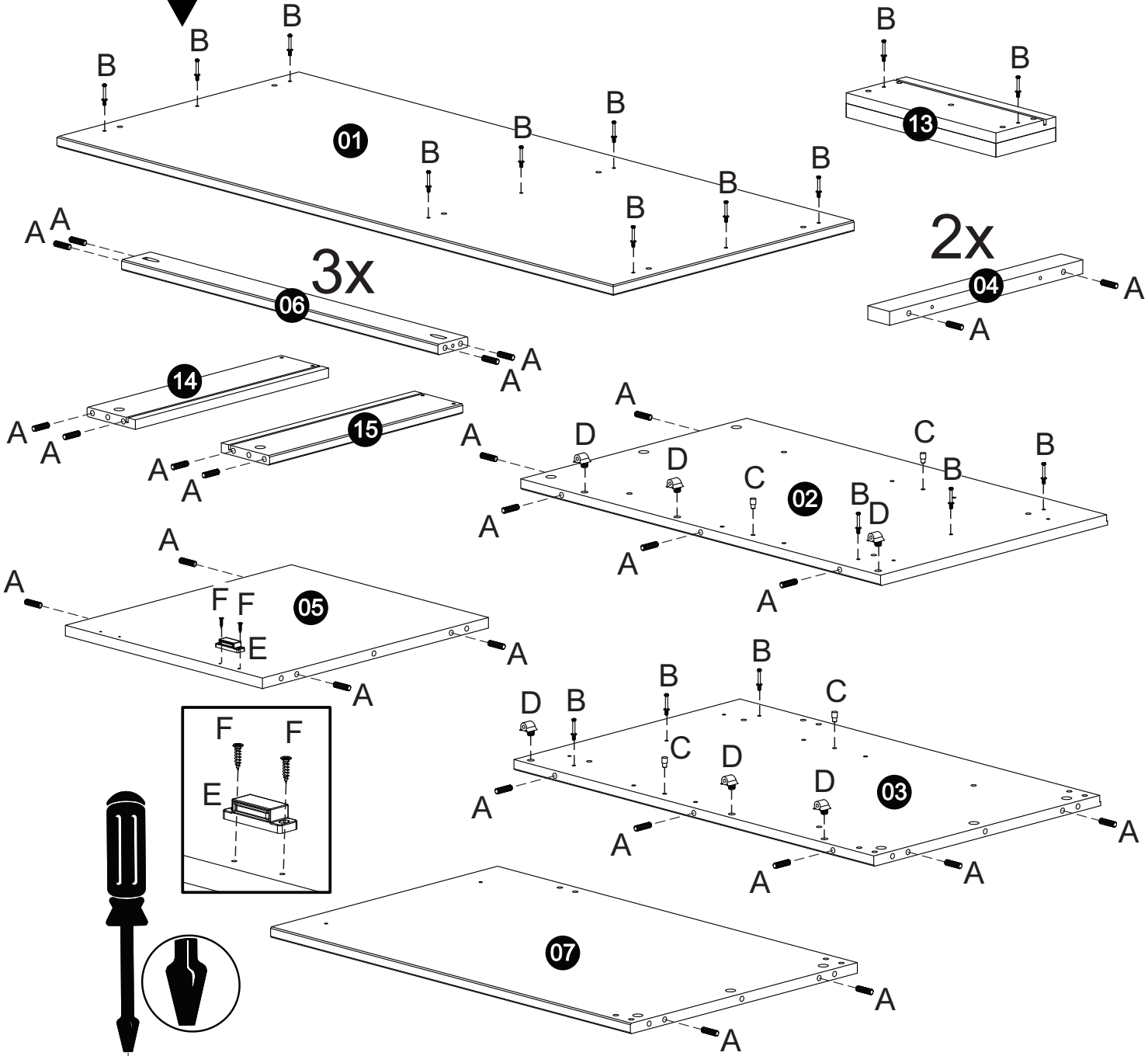

2

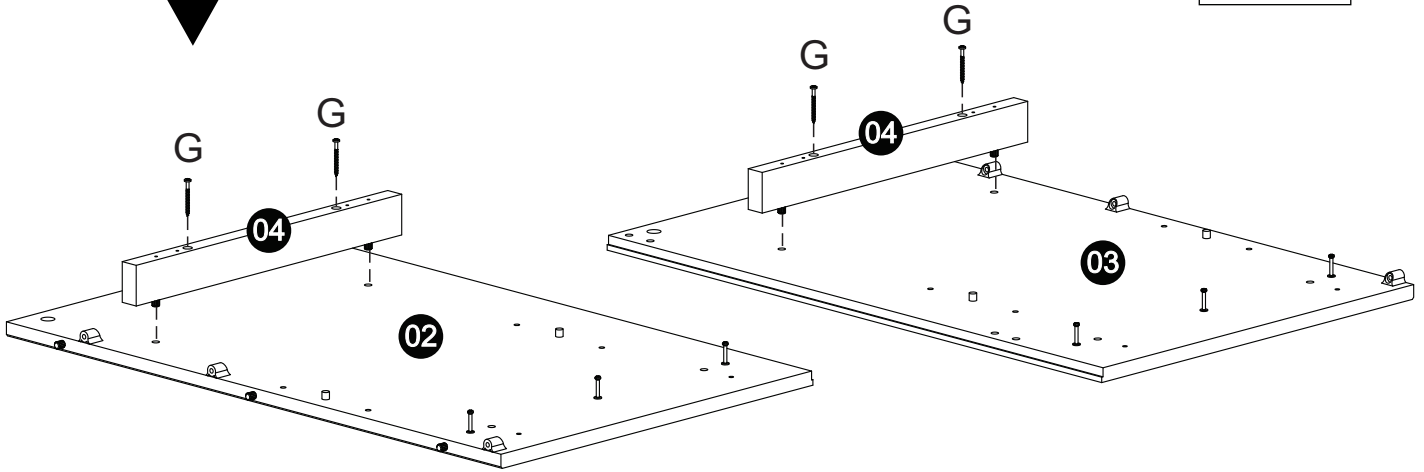
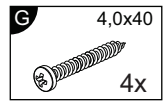

3

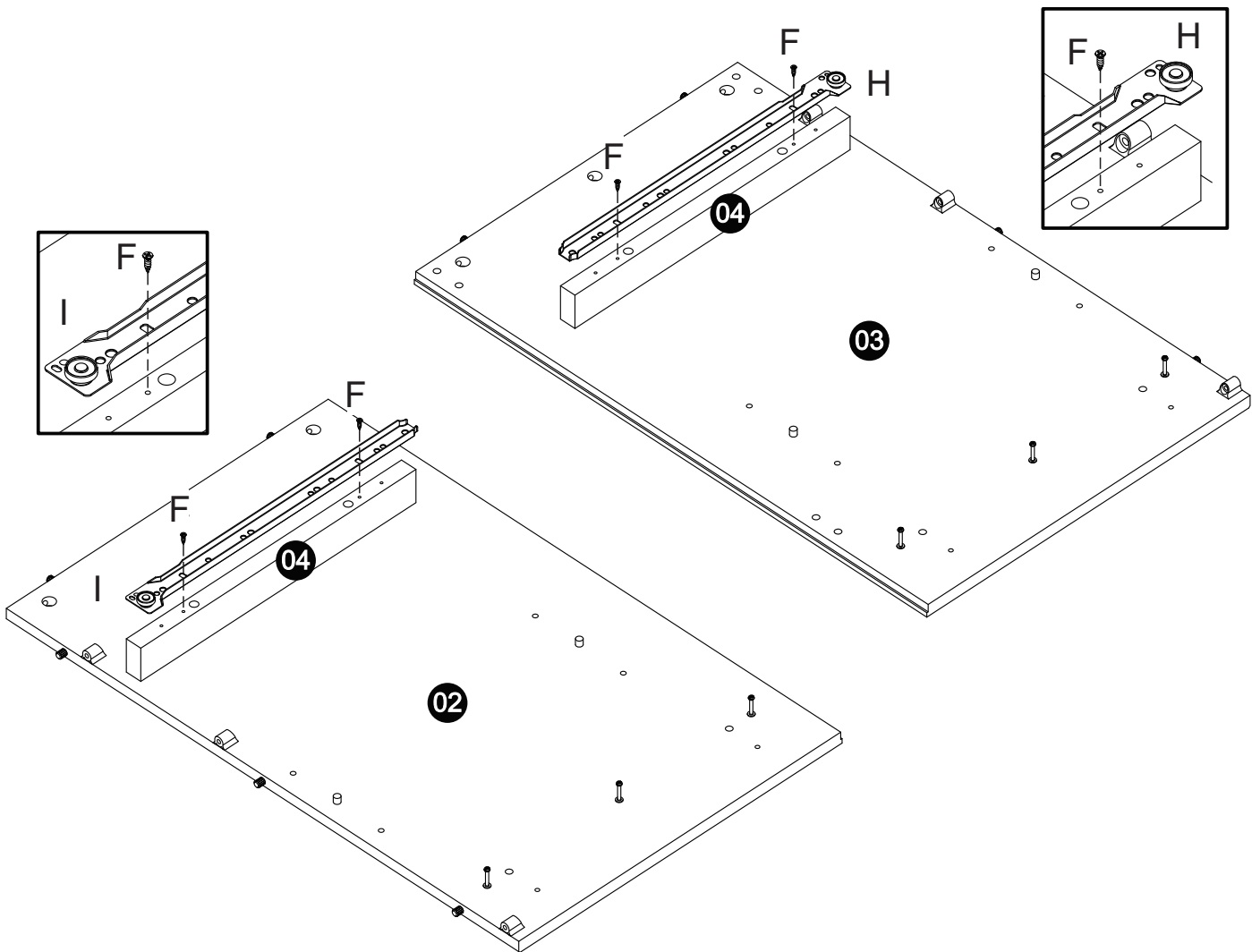
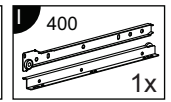
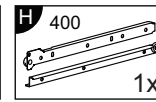
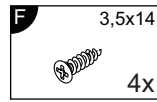

4

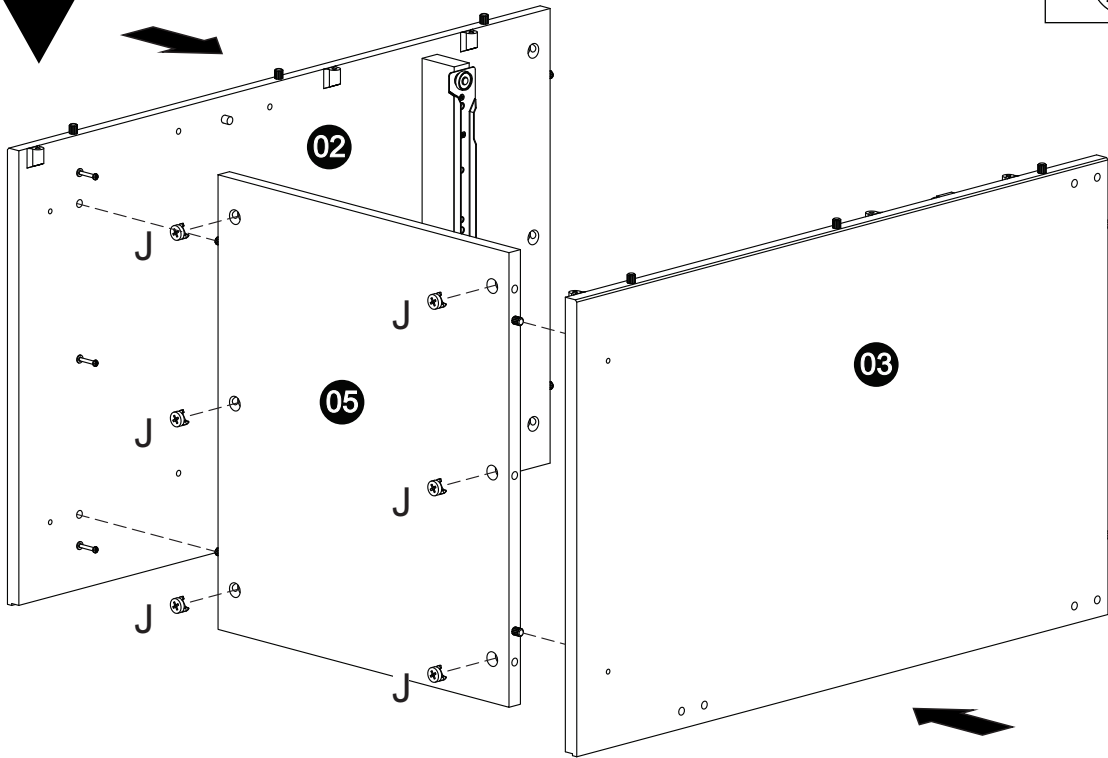
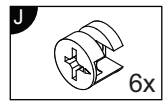

5

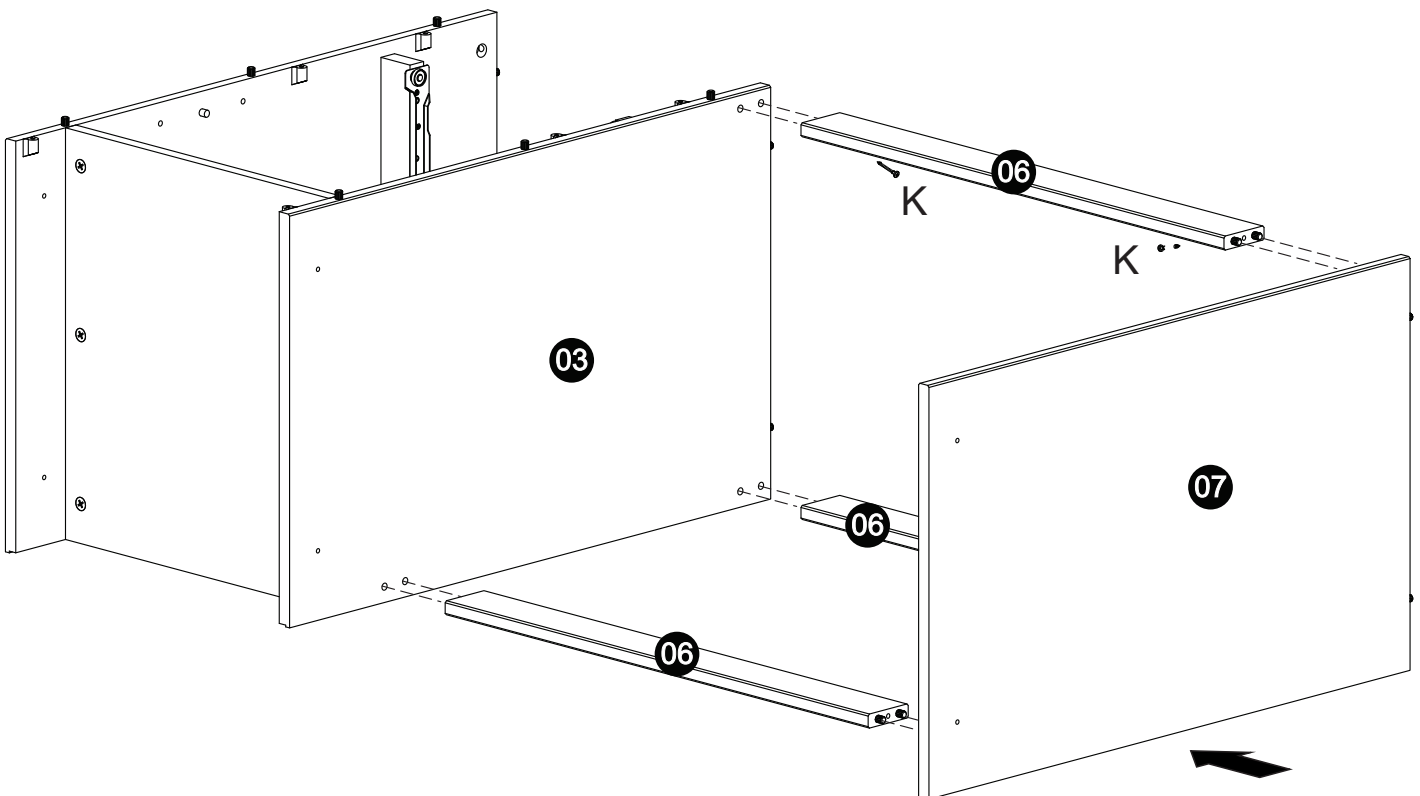
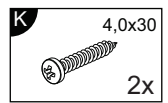

6

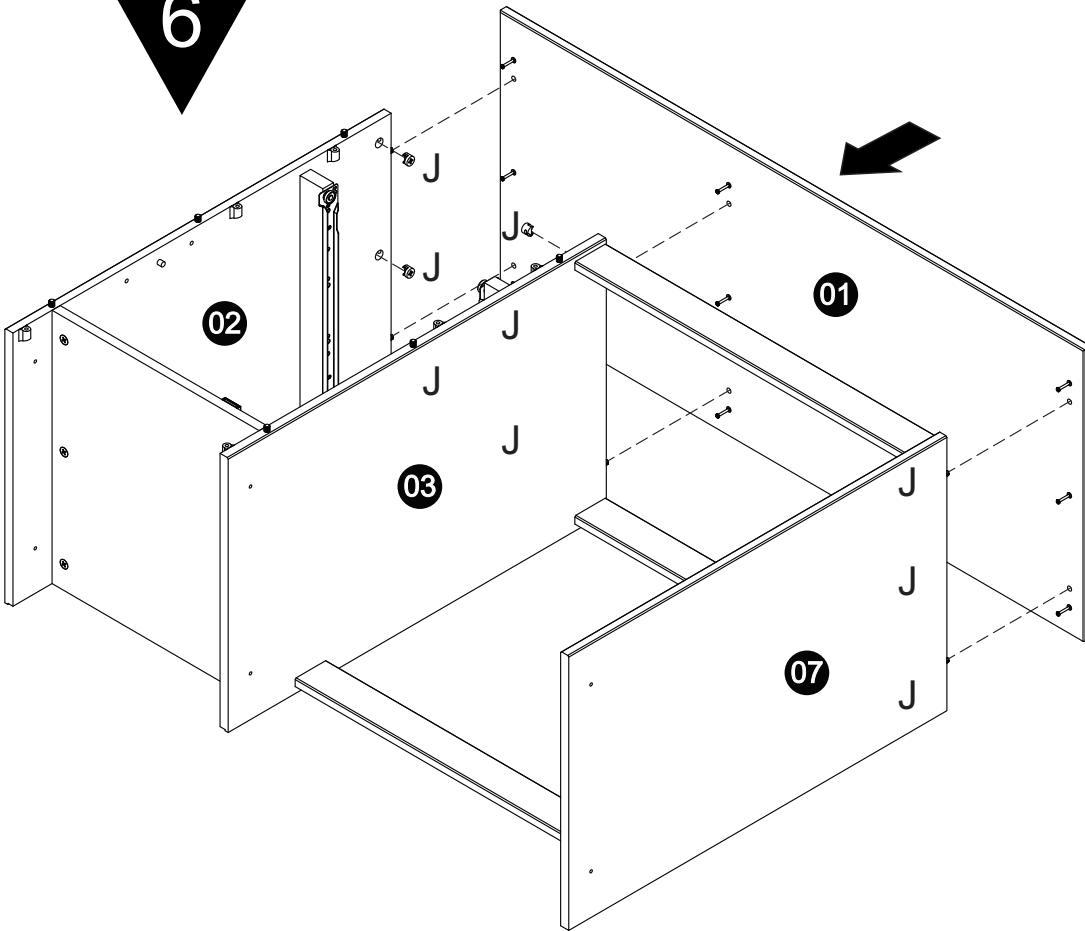
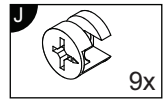

7

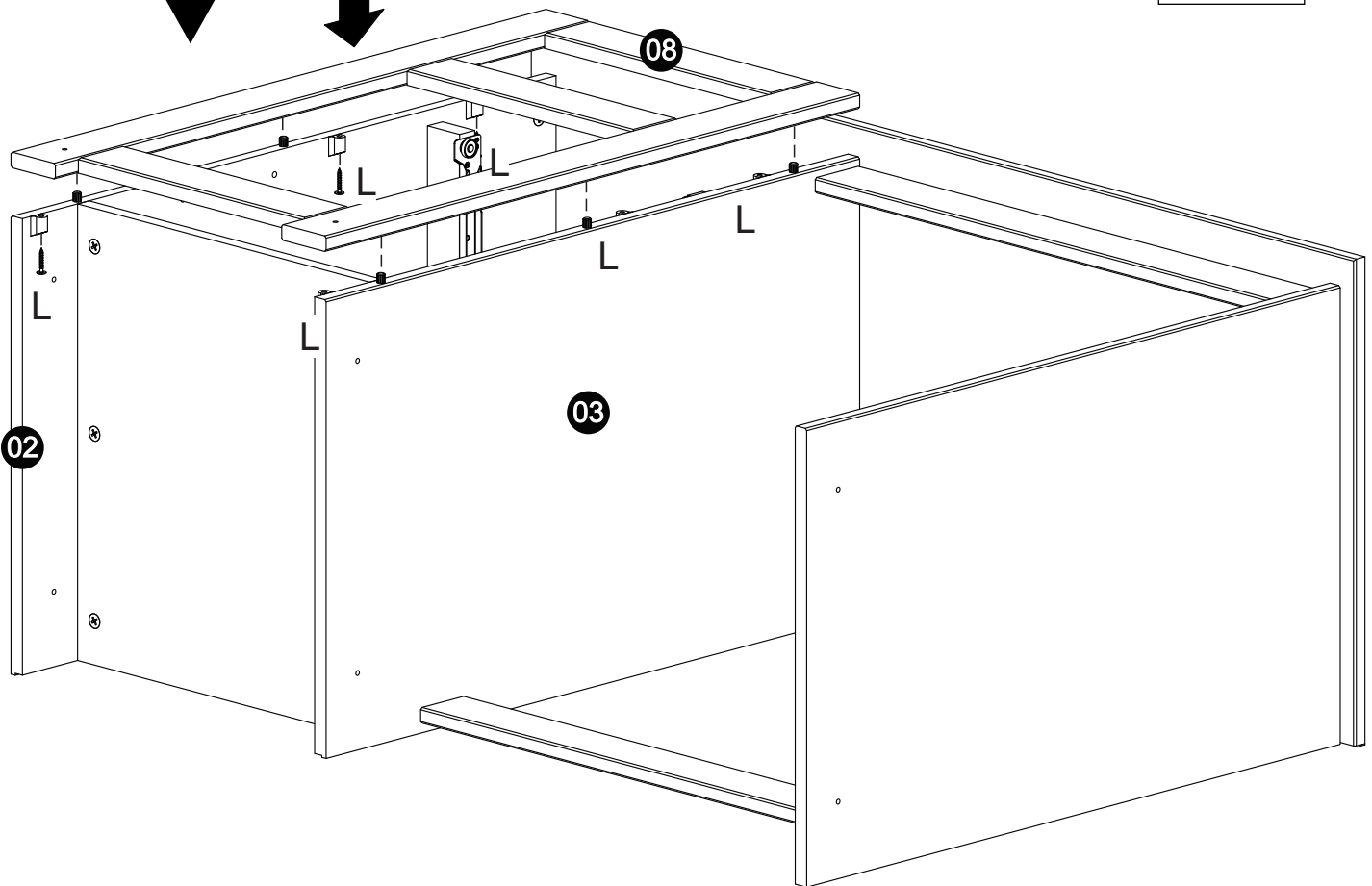
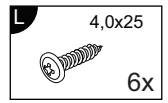

8

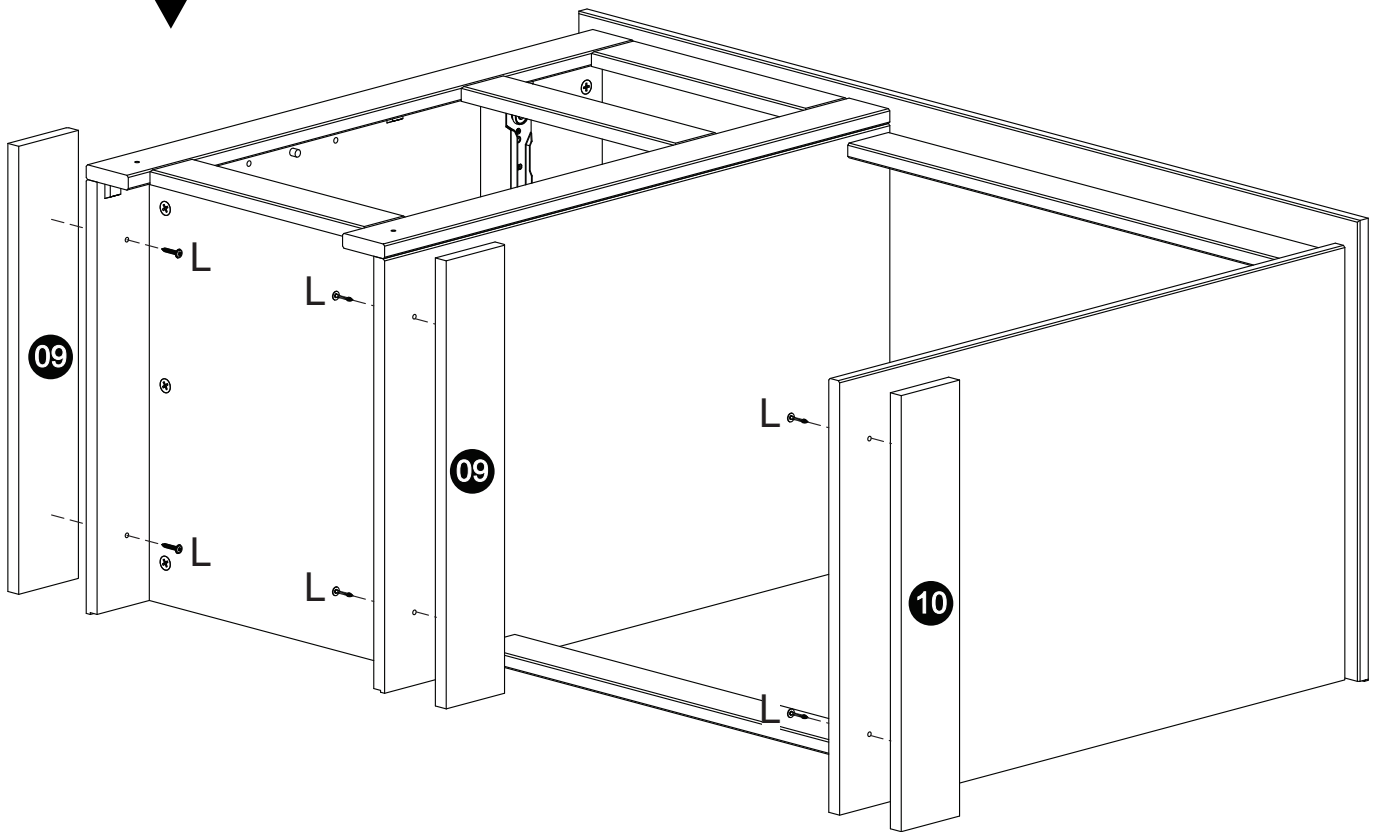
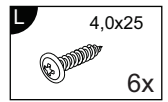

9

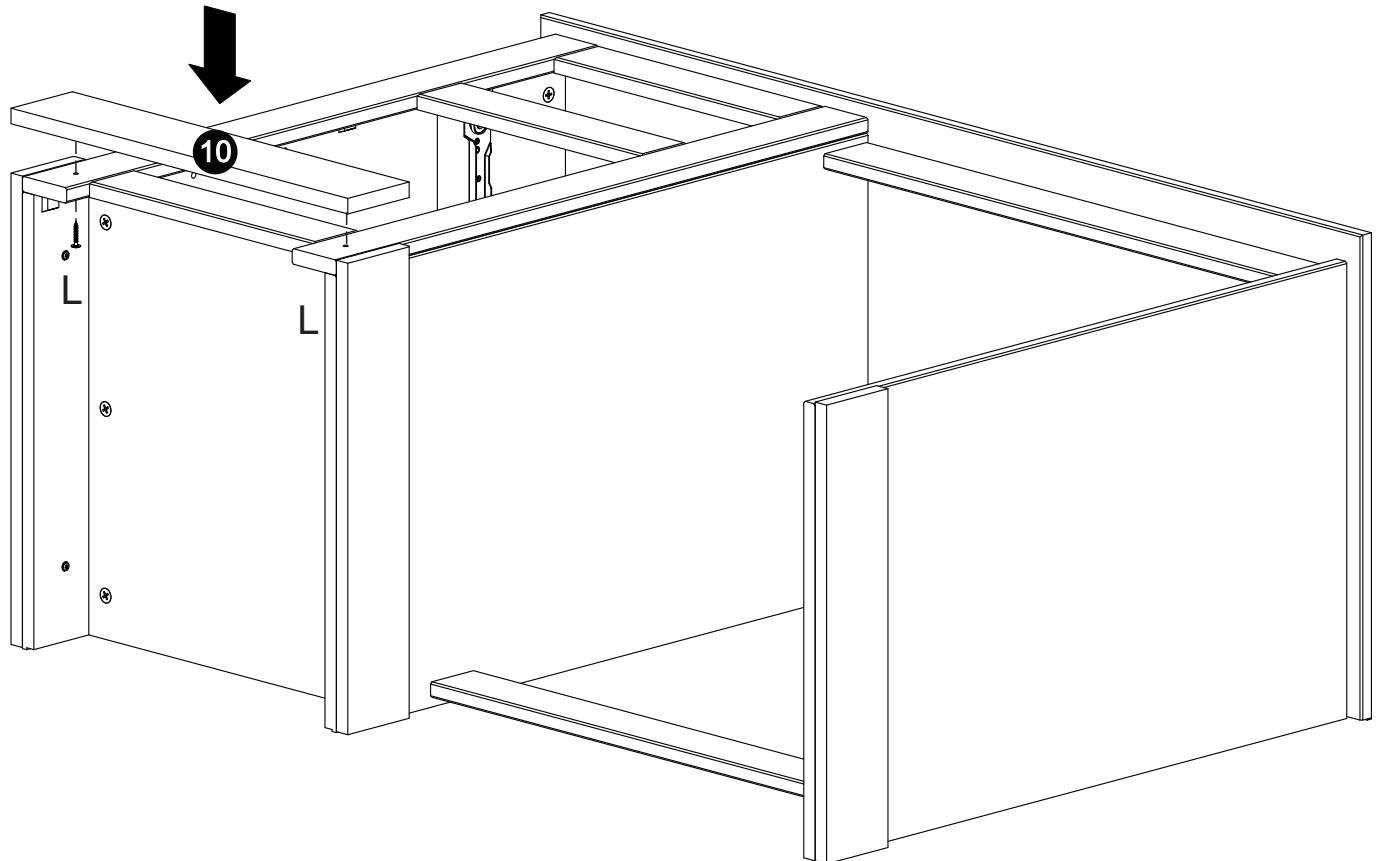
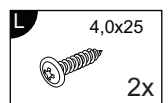

10

K 4,0x30
4x

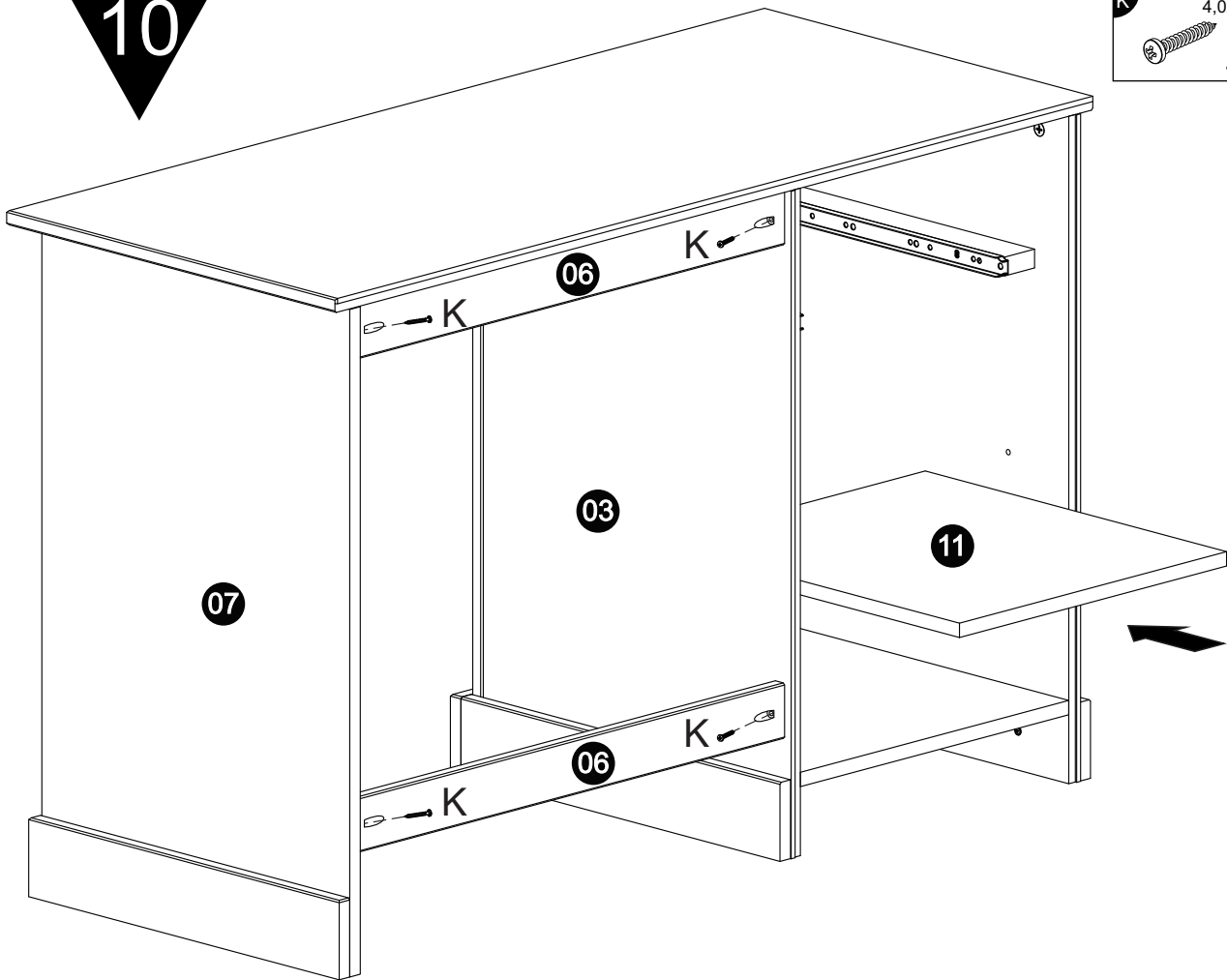

11

M 8x8
20x

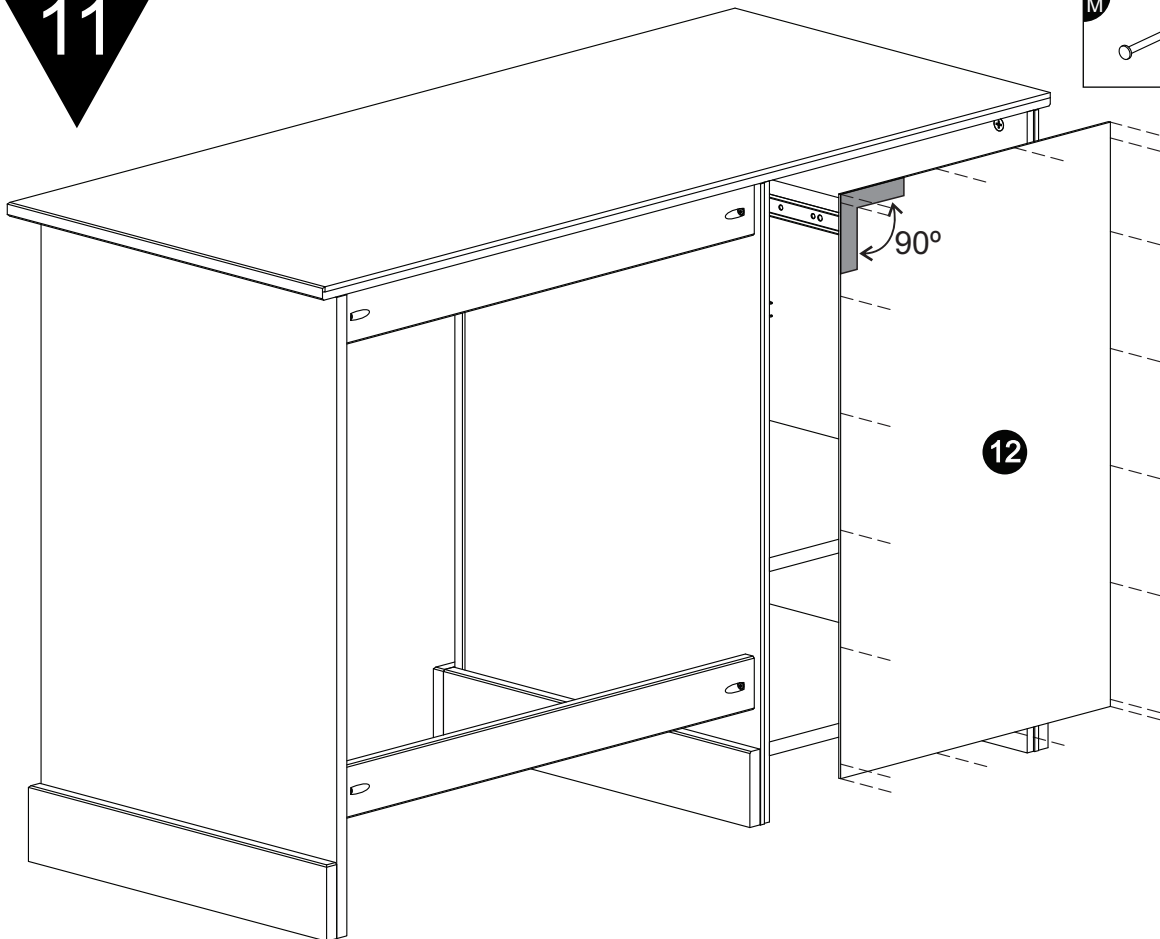

12

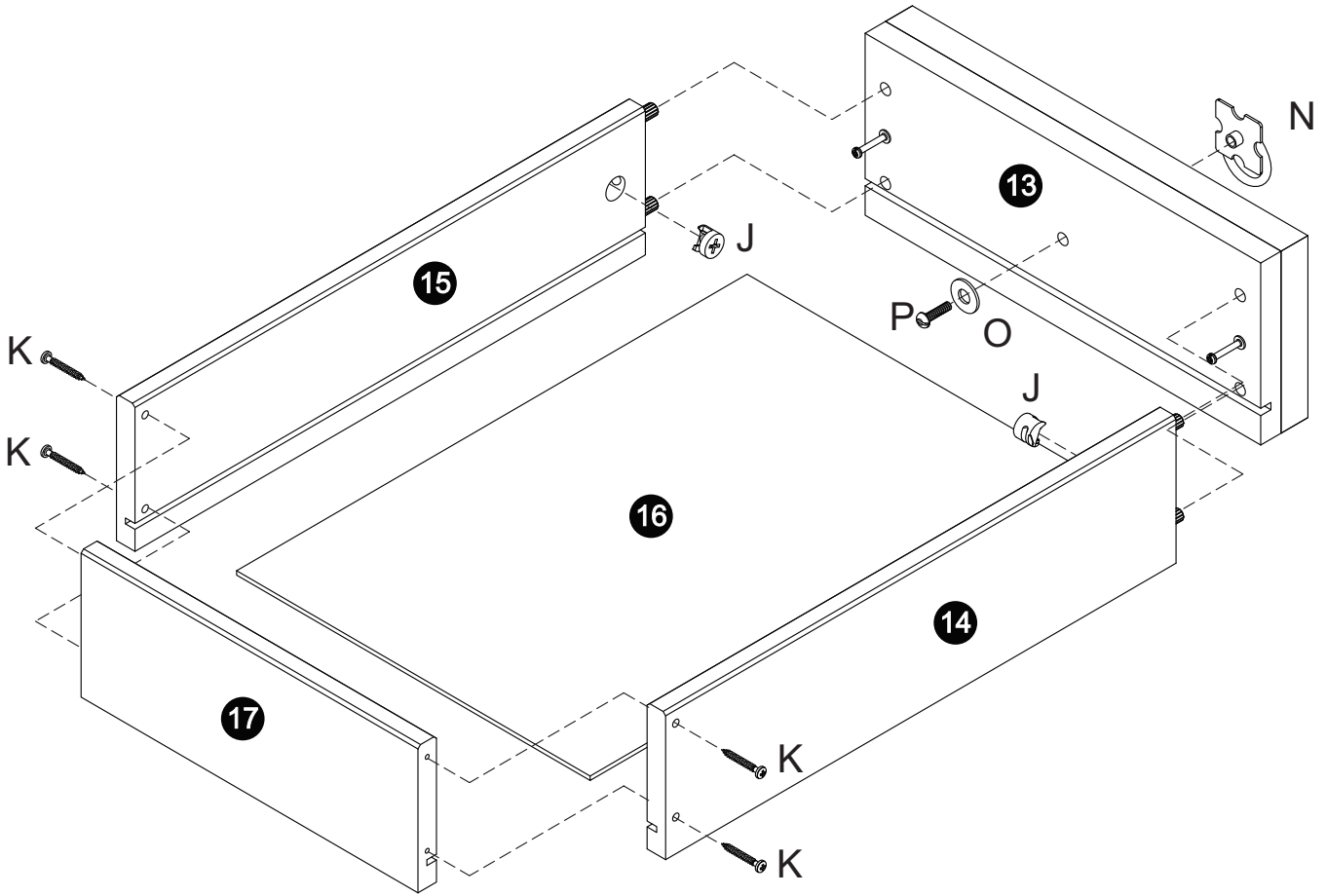
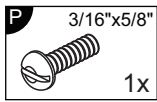
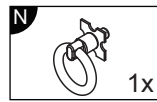
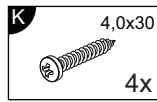
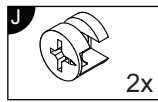

13

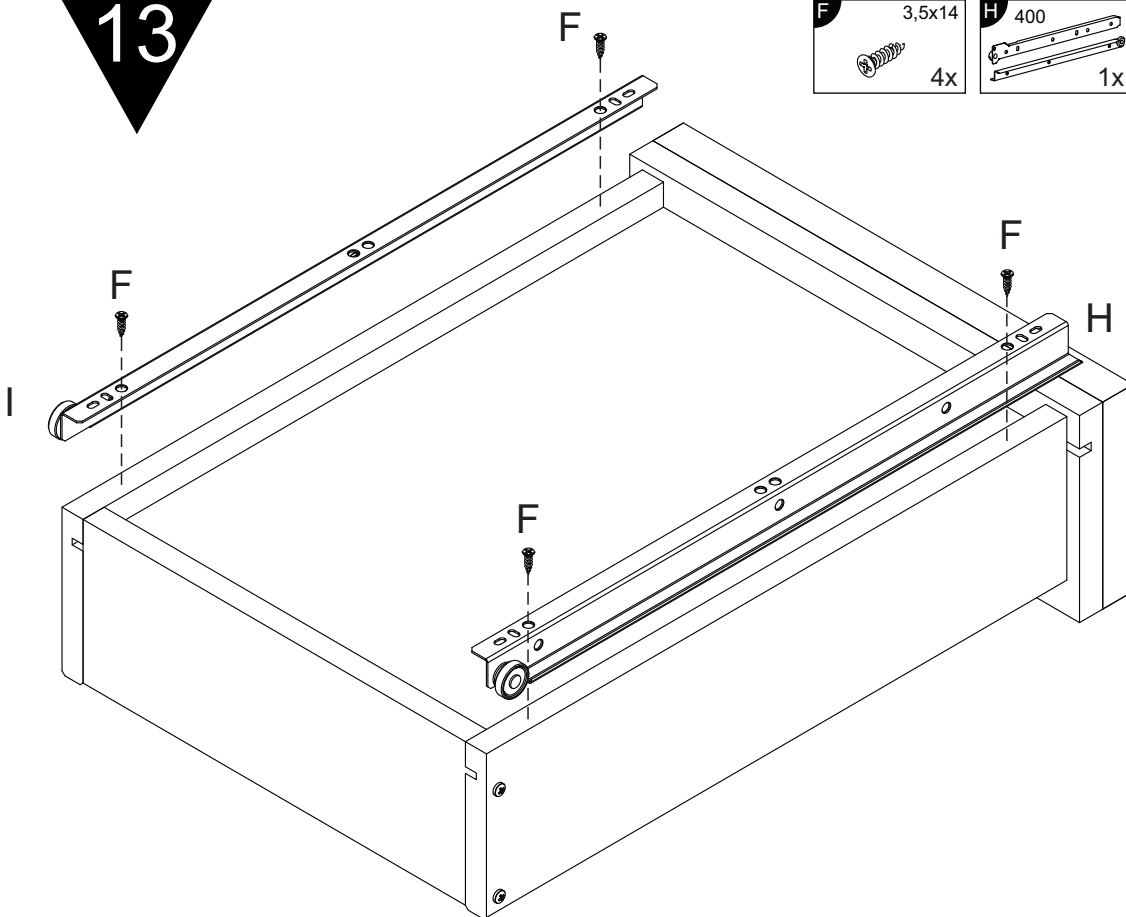
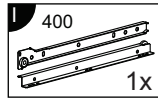
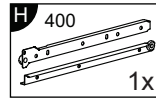
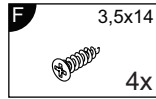

14

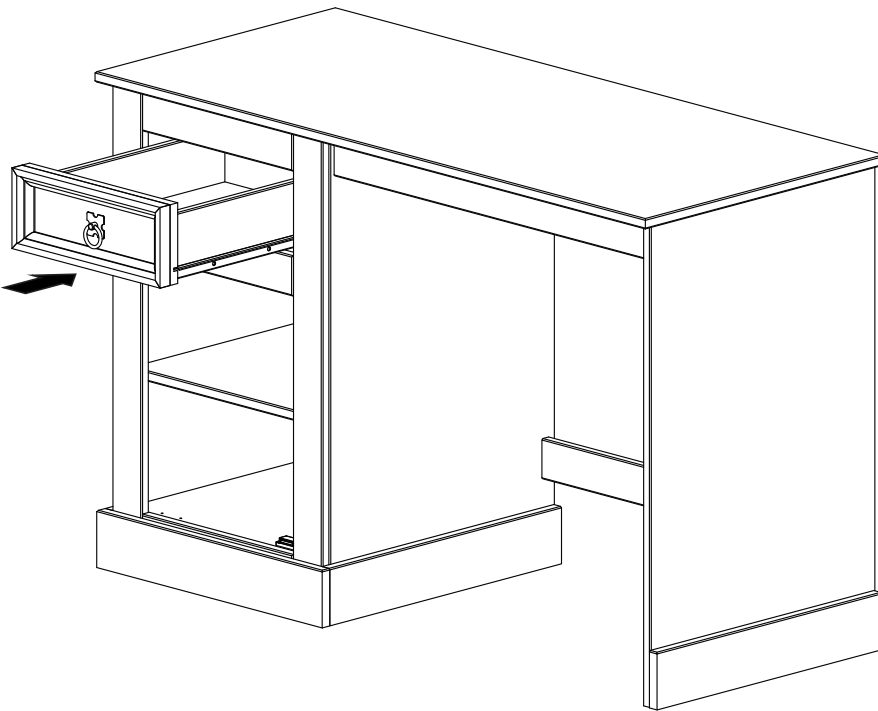
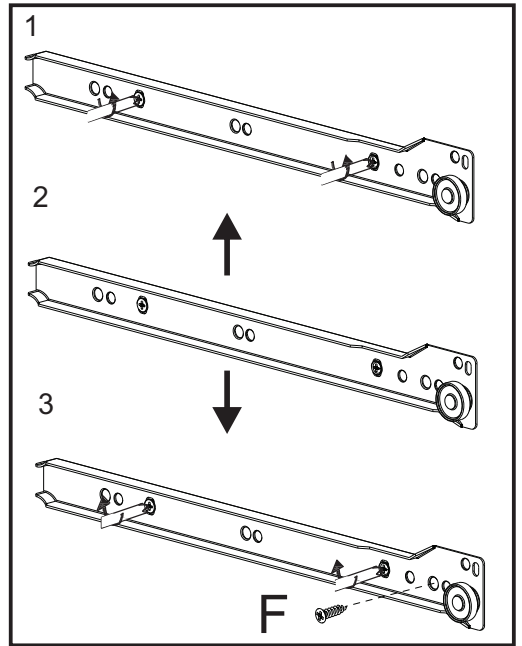
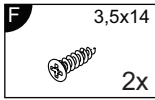

15

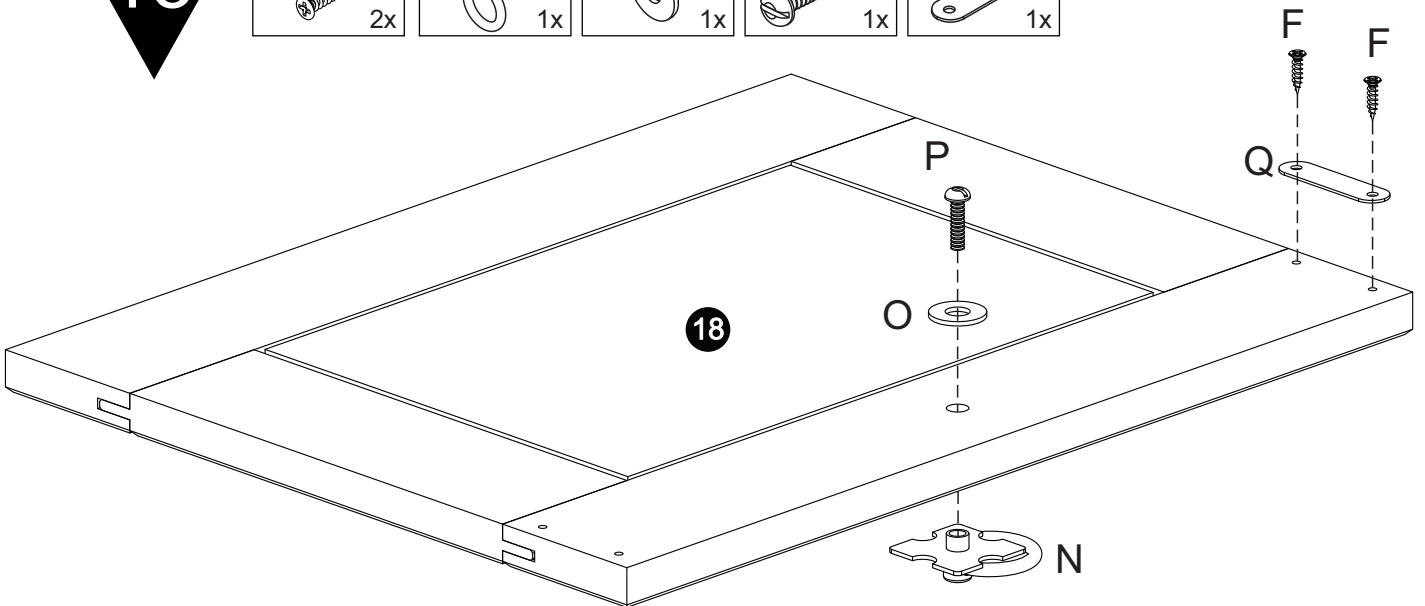

16

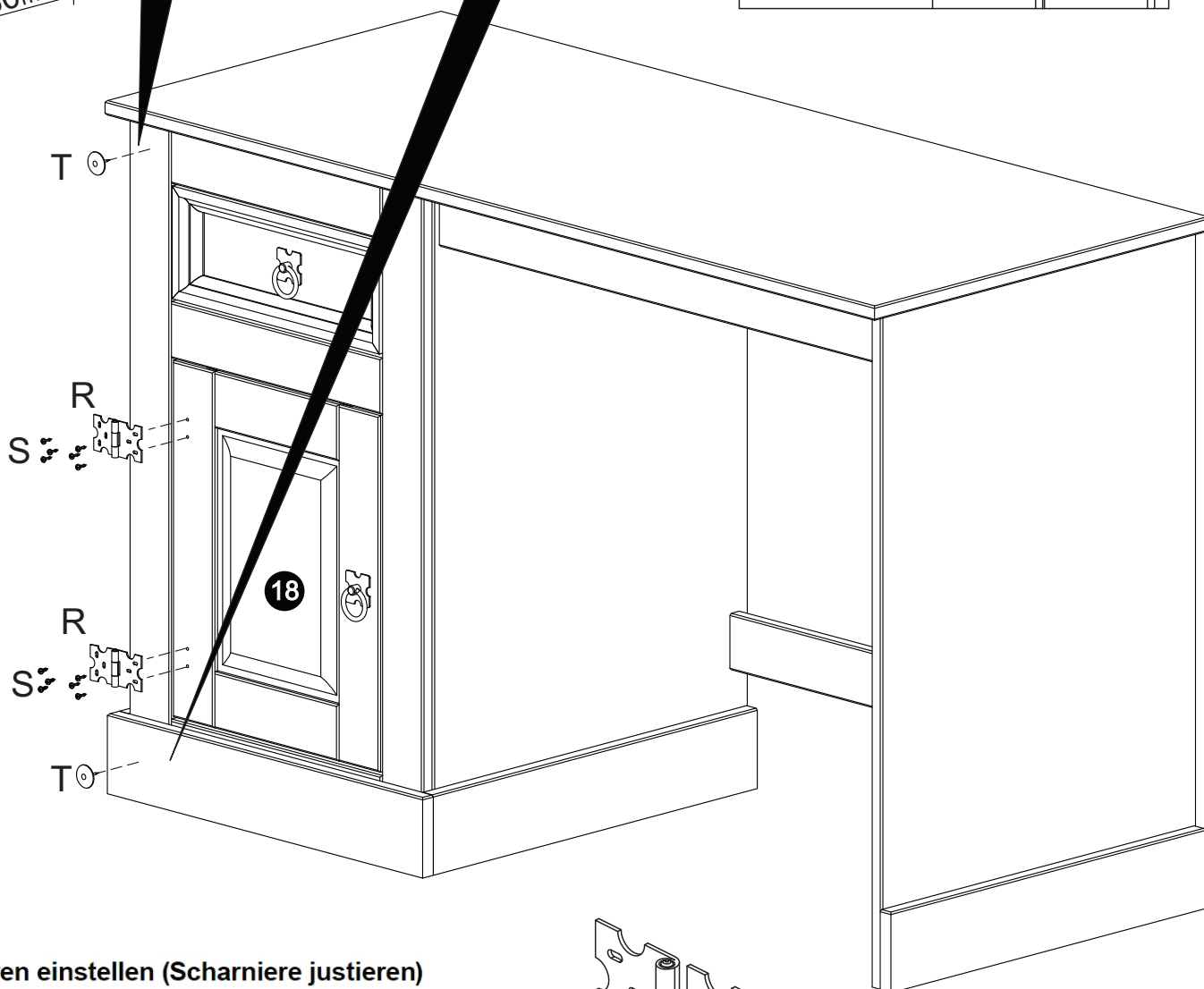
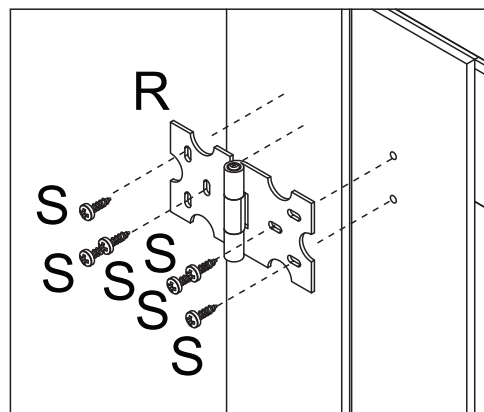
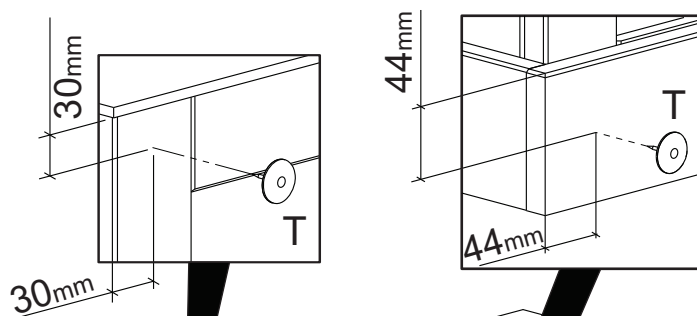
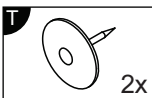
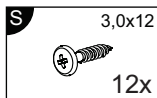
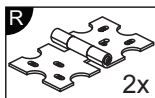

Türen einstellen (Scharniere justieren)
Adjusting the doors (adjusting the hinges)
Régler les portes (ajuster les charnières)
Sistemare le porte (regolare le cerniere)
Deuren instellen (scharnieren afstellen)
Nastawić drzwi (wyregulować zawiasy)
Vyrovnejte dvířka (seřid'te závěsy)
Nastavenie dverí (nastavenie závesov)
Állítsa be az ajtókat (állítsa be a zsanérokát)
Reglare ușii (ajustare balamale)
Капıларın аярланması (menteşelerin seviye ayarı)
Регулировка дверей (регулировка шарнира)

