

WSCH207-60

70-186-17

Montageanleitung / Assembling instruction / Notice de montage / Montaje de instrucción / Instrukcja montażu / Сборка инструкция / Montáž instrukce / Montáž inštrukcie / Szerelési utasítás / Сглобяване инструкция / Kurulum Talimatları / Montagem de instrução / Sestavljanje navodila / Montage instructie / Склапање инструкцију / Asamblarea de instrucțiuni / Sastavljanje upute / Monteringsinstruktion / Istruzioni di montaggio / Збірка інструкція / Montāžas instrukcija / Montavimo instrukcija / Paigaldusjuhend

DE- Vor die montage, bitte beiliegende anweisungen folgen / **EN-** Before starting, refer to the assembling advice in annex / **NL-** Voordat u begint zie de installatie-instructies / **FR-** Avant de commencer, se reporter aux conseils de montage en annexe / **PL-** Przed rozpoczęciem zapoznać się z instrukcją montażu / **RU-** Перед началом обратитесь к инструкции по установке / **CZ-** Před zahájením naleznete v montážním návodu / **SK-** Pred začatím nájdete v montážnom návode / **HU-** Megkezdése előtt olvassa el a telepítési utasításokat / **BG-** Преди да започнете се отнасят към инструкциите за инсталиране / **TR-** Kurulumla başlamadan önce, montaj talimatnamesini sirasiyla takip edin. / **ES-** Antes de comenzar referirse a las instrucciones de instalación / **P-** Antes de começar a consultar as instruções de instalação / **SLO-** Pred začetkom glejte navodila za namestitvev / **SRB-** Пре почетка погледајте упутства за инсталацију / **RO-** Înainte de a începe să consultați instrucțiunile de instalare / **HR-** Prije početka pogledajte upute za instalaciju / **S-** Innan du börjar se Installationsanvisningen / **I-** Avanti di cominciare, riportate agli consigli di montaggio / **UKR-** Перед початком зверніться до інструкції з установки / **LV-** Pirms sākt montāžu, iepazīties ar instrukciju / **LT-** Prieš pradant kreiptis į montavimo instrukcija / **EST-** Enne käivitamist vaadake paigaldusjuhiseid

www.washtower.com

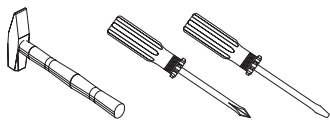
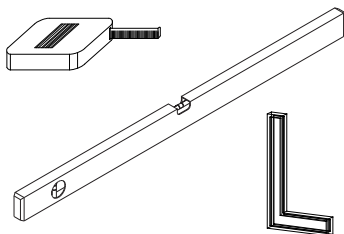
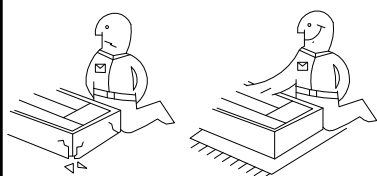
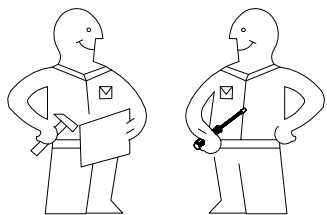

10 + 13

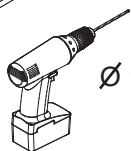
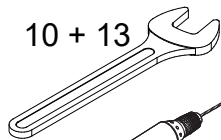

Ø 10 mm

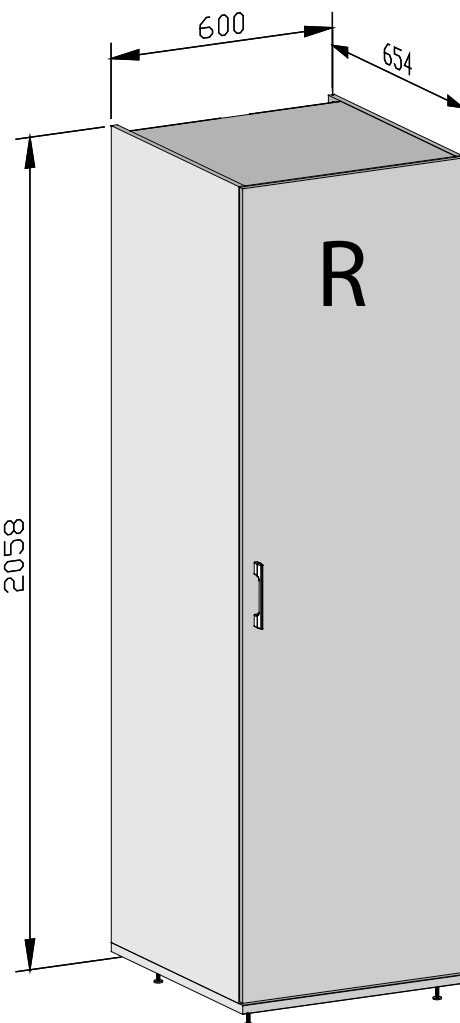
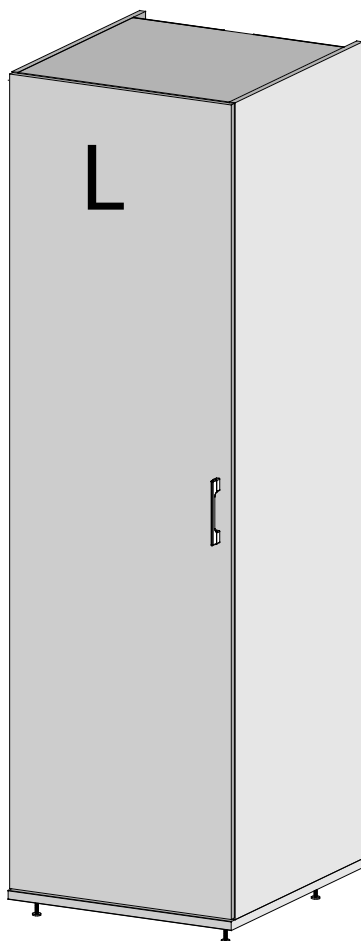
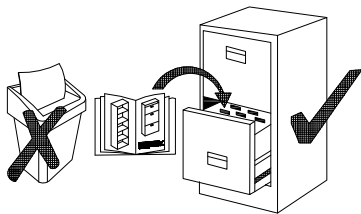

Nr	Dimension	Colli 1 / 2	Colli 2 / 2
WTK 1	2001 x 634 x 16		1
WTK 2	2001 x 634 x 16		1
WTK 3	600 x 654 x 22	1	
WTK 4	568 x 570 x 16	1	
WTK 5	568 x 400 x 16	1	
WTK 6	2004 x 577 x 2.5		1
WTK 7	1995 x 596 x 16		1

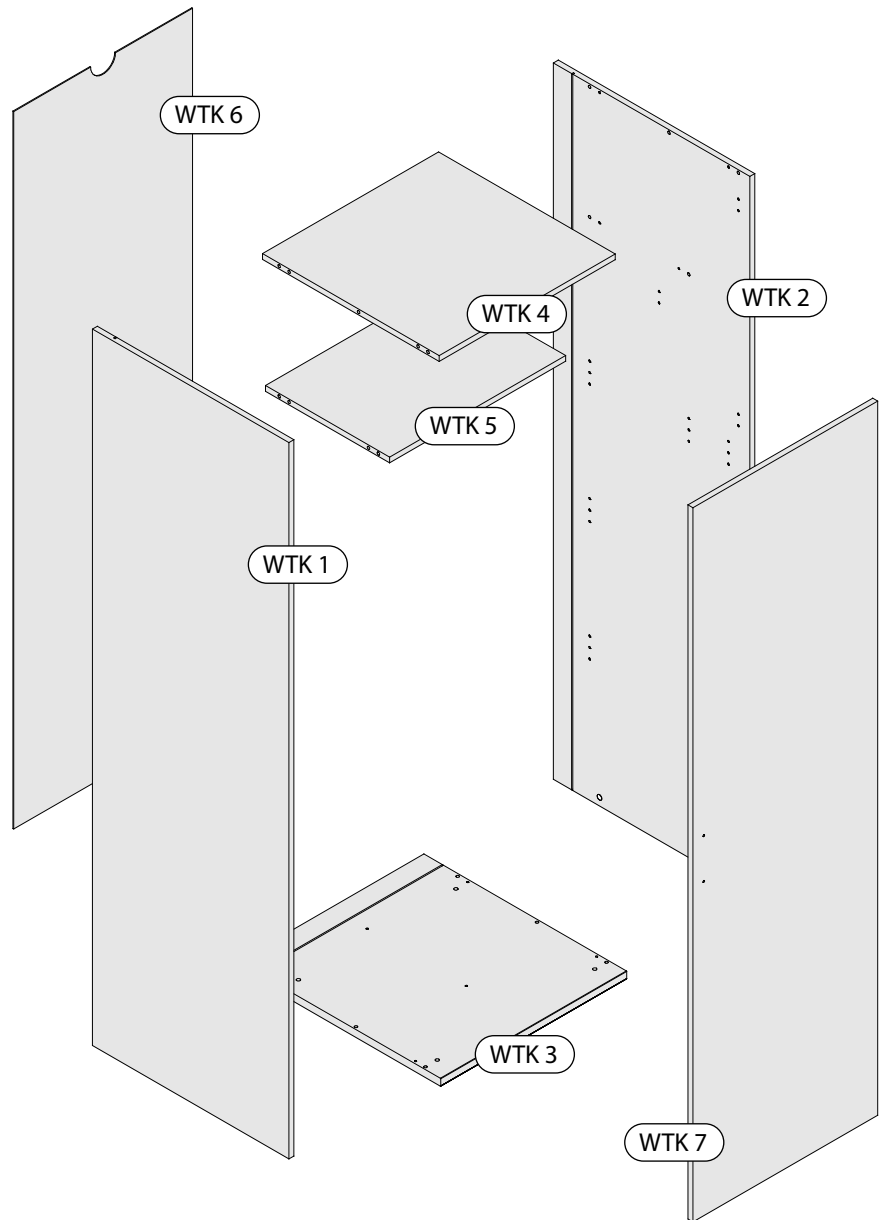

<p>12 mm 12 x a1</p>	<p>20 mm 12 x s1</p>	<p>8 x 30 mm 16 x b1</p>	<p>12 x b2</p>	<p>7 x b3</p>	<p>3 x 20 mm 8 x s2</p>
<p>4 x b4</p>	<p>50 mm 4 x s3</p>	<p>4 x 20 mm 12 x s4</p>	<p>4 x b5</p>	<p>4 x 28 mm 4 x s5</p>	<p>1 x b6</p>
<p>2 x b7</p>	<p>4 x b8</p>	<p>4 x b9</p>	<p>3,5 x 13 mm 12 x s6</p>	<p>1 x b10</p>	<p>M4 x 20 mm 2 x s7</p>
<p>2 x b11</p>	<p>5 x 60 mm 1 x s8</p>	<p>1 x b12</p>	<p>1 x b13</p>		

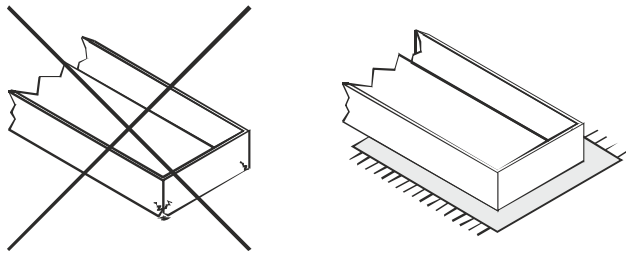

1

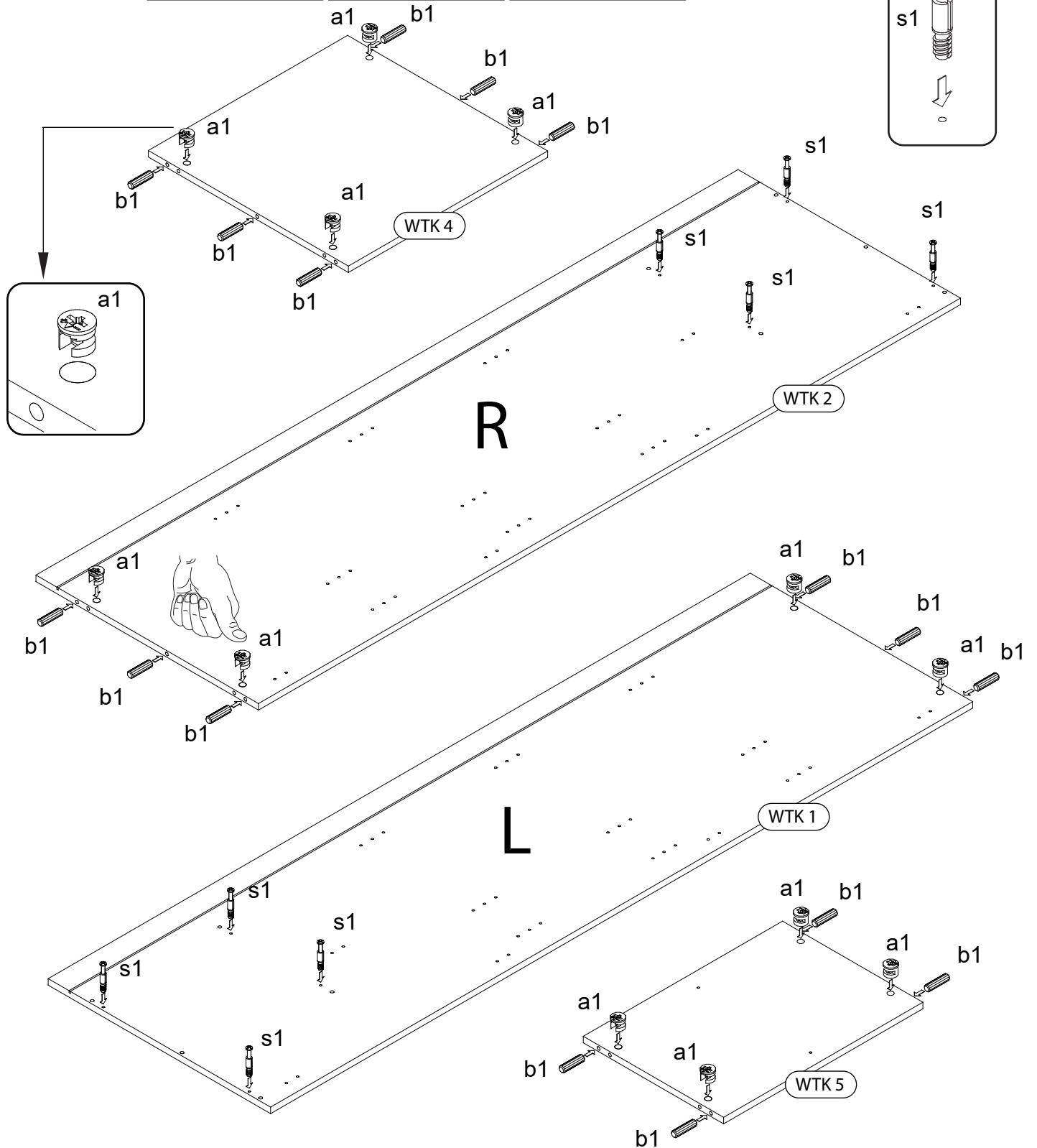
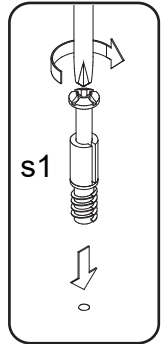
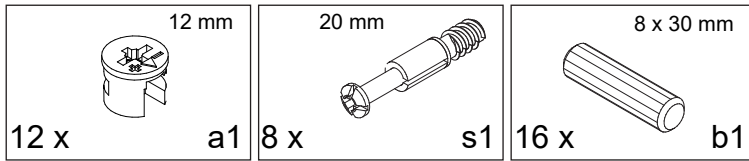

2

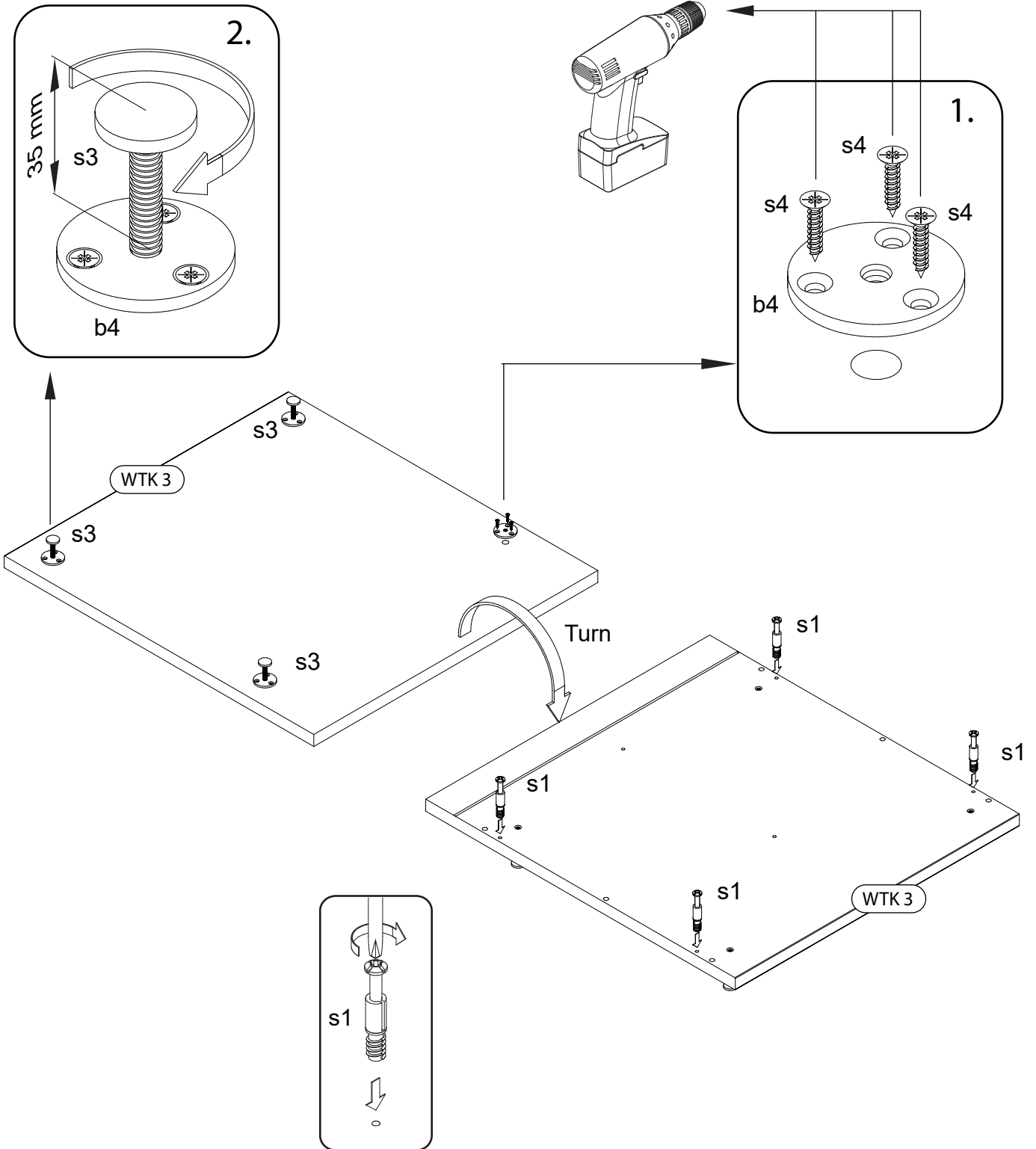
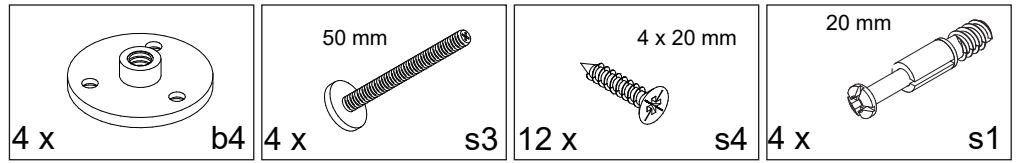

3

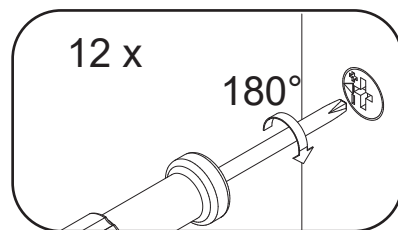
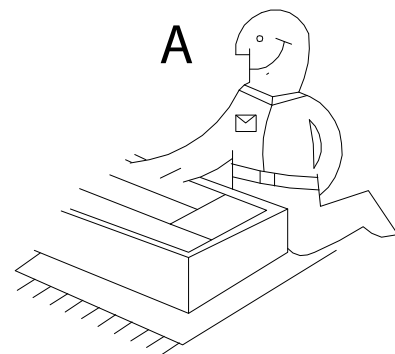
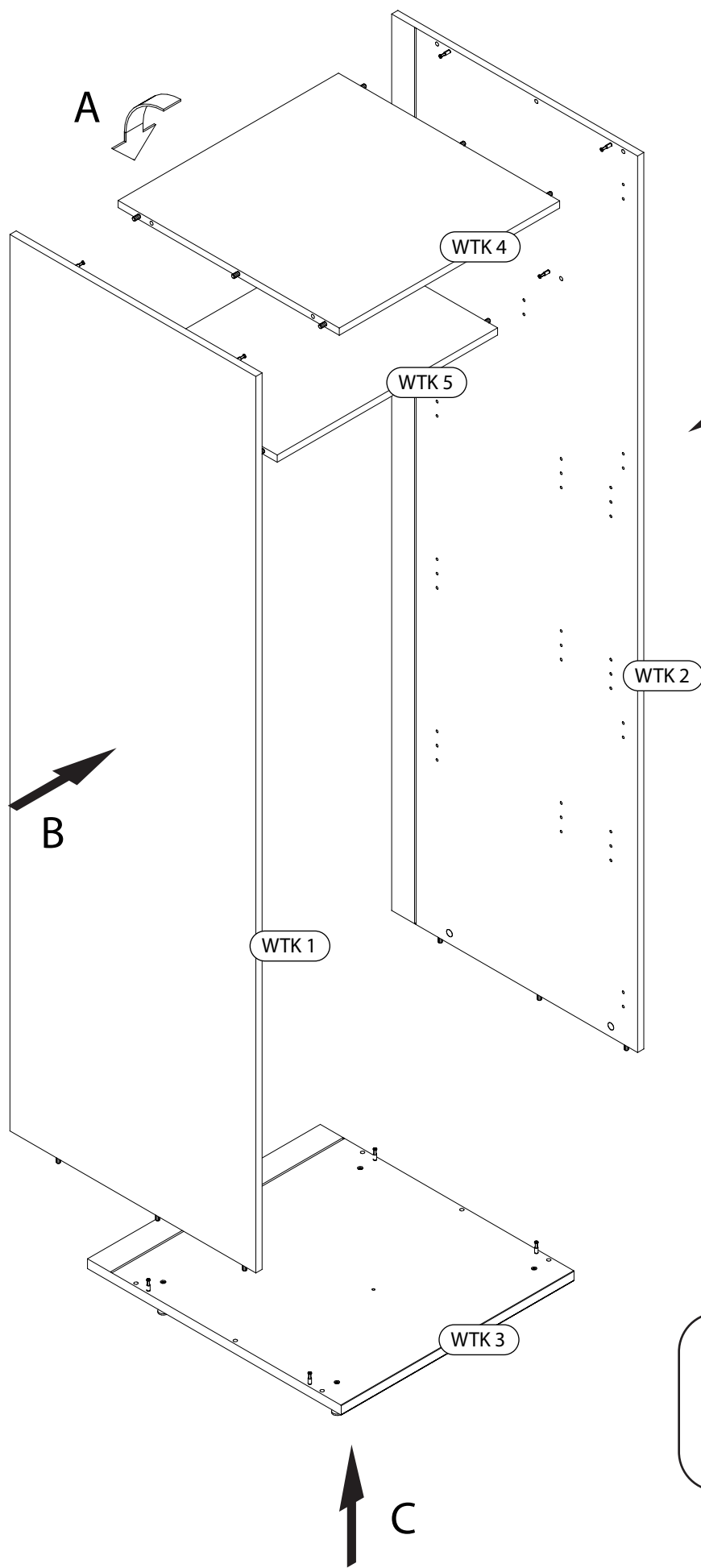

4

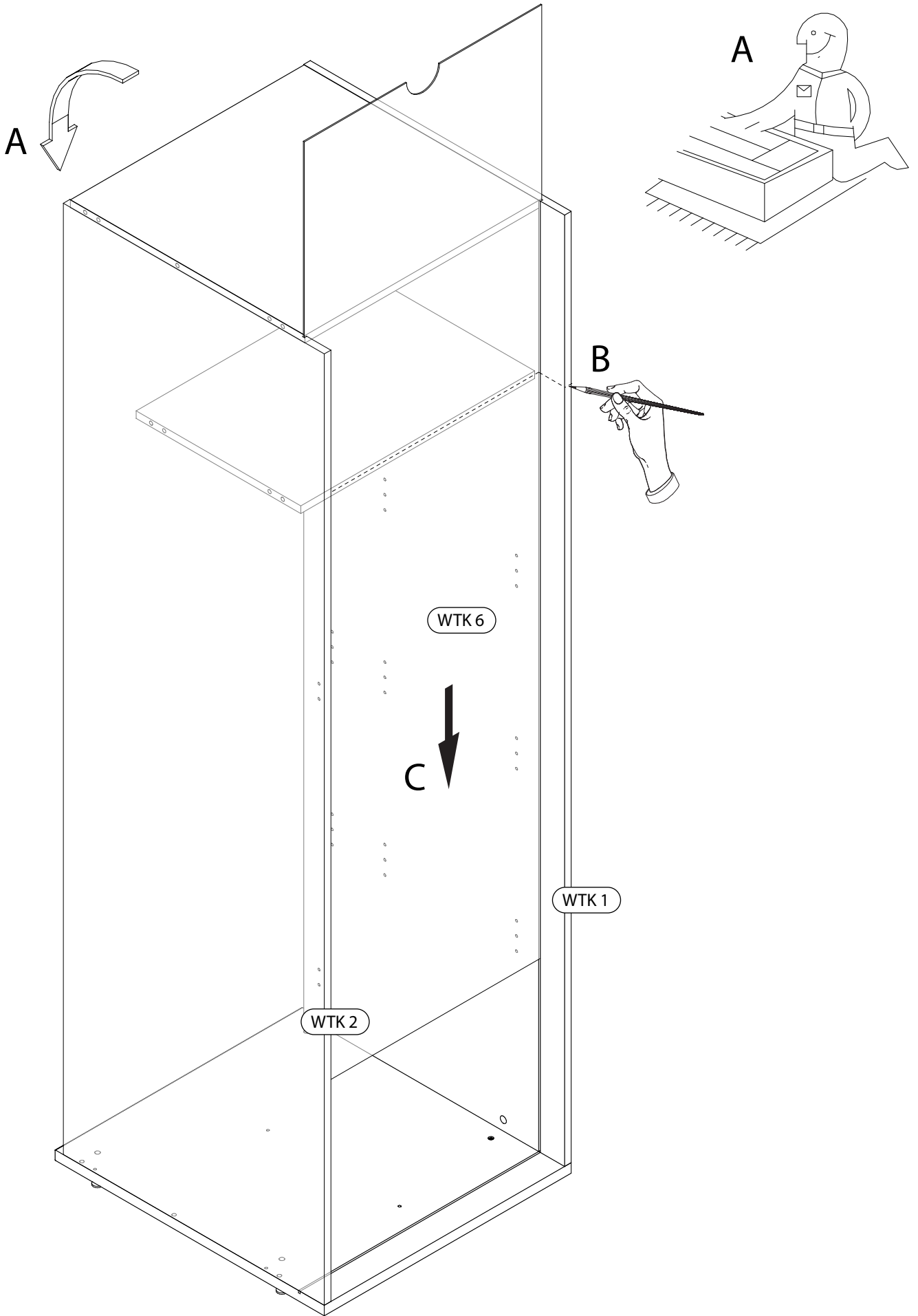

5

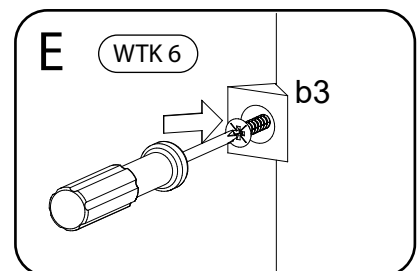
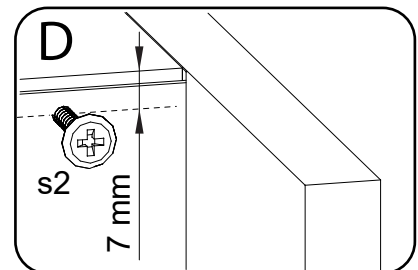
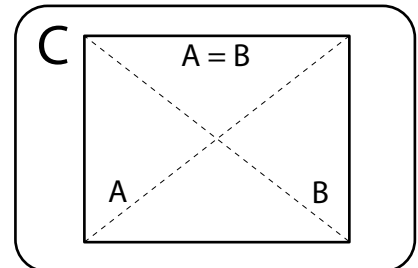
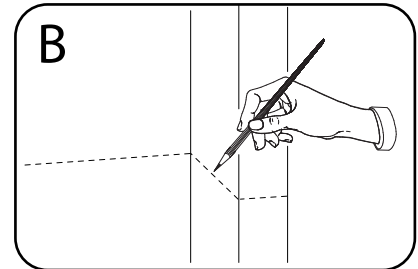
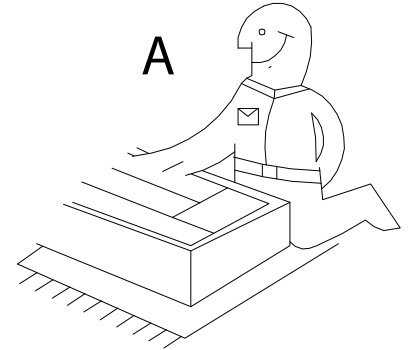
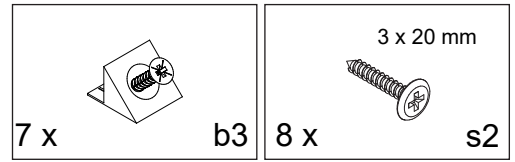
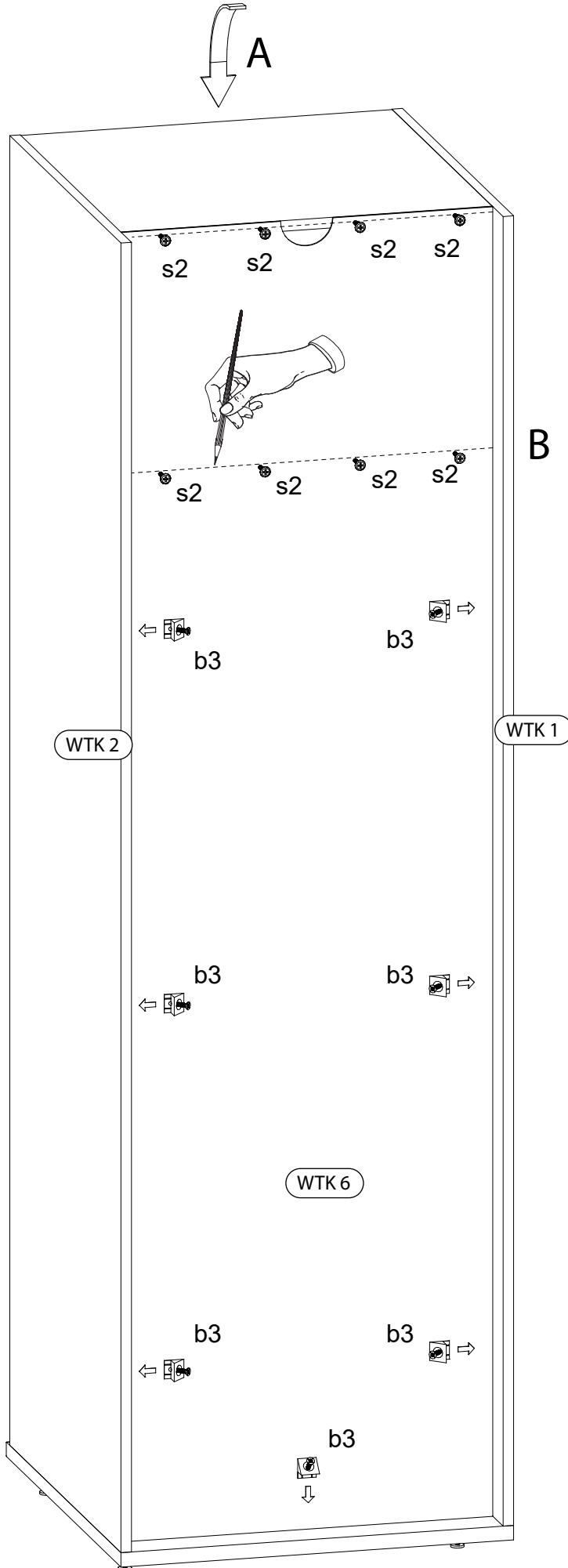

6

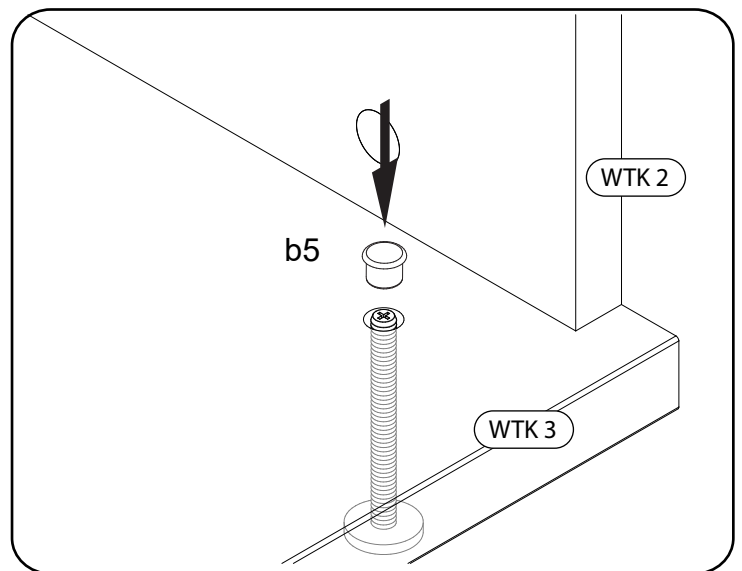
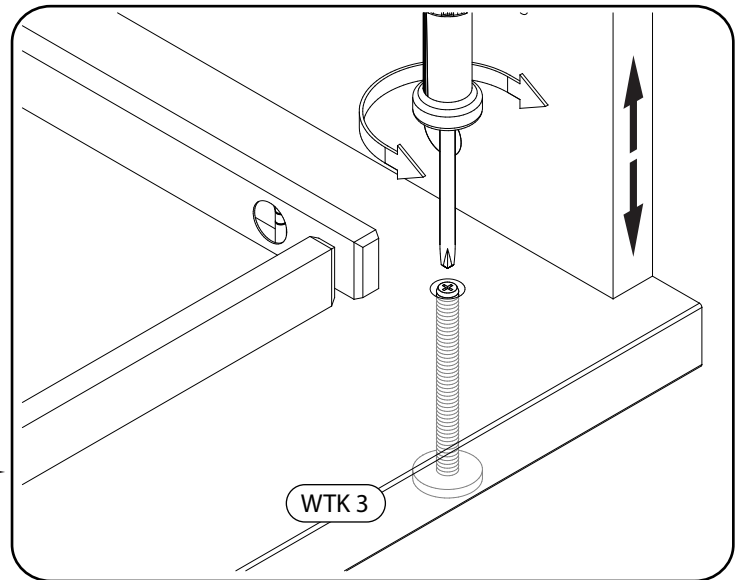
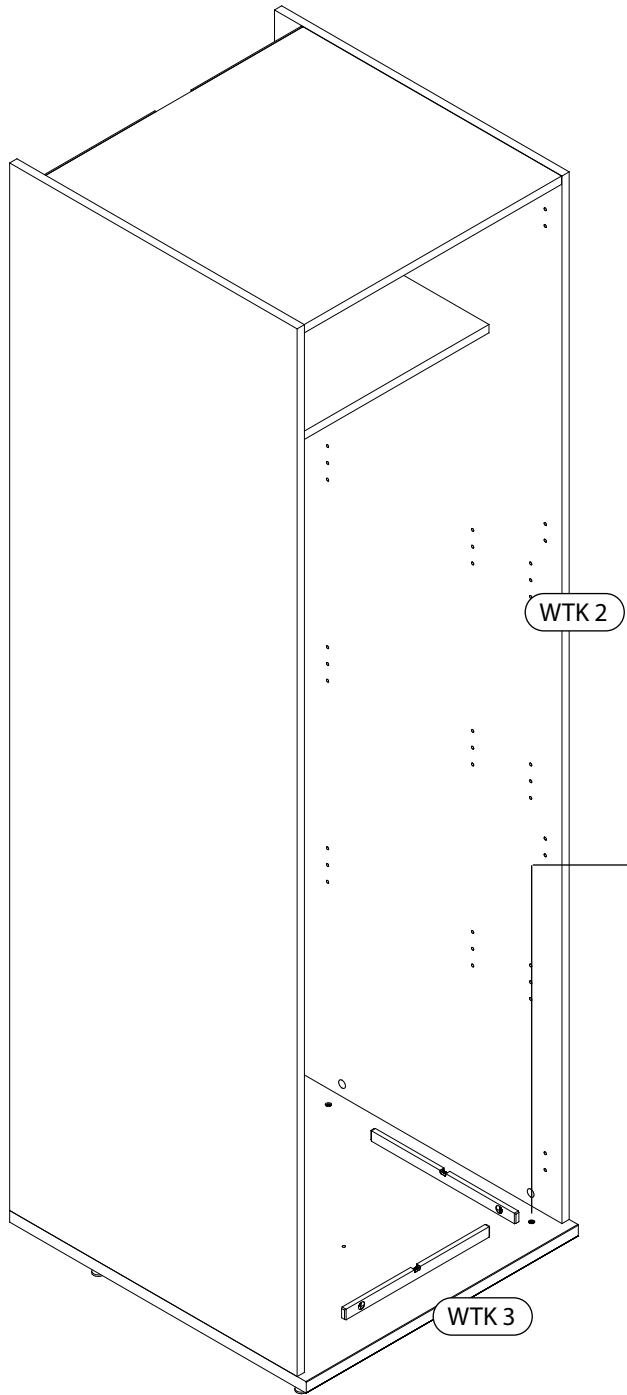
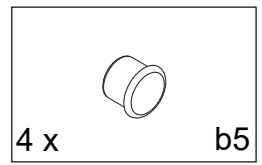

7

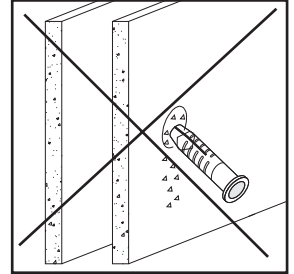
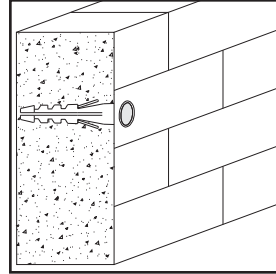
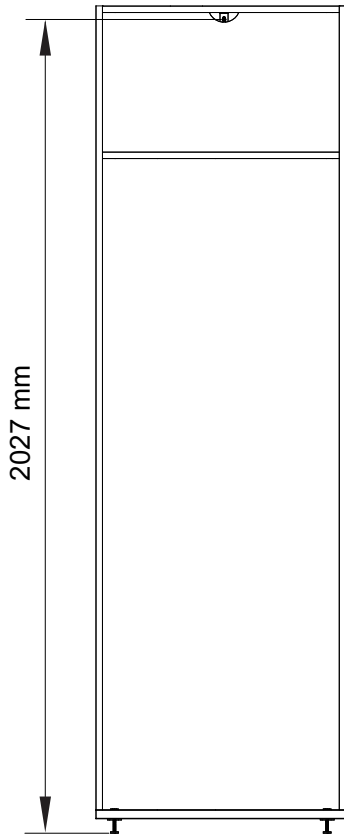
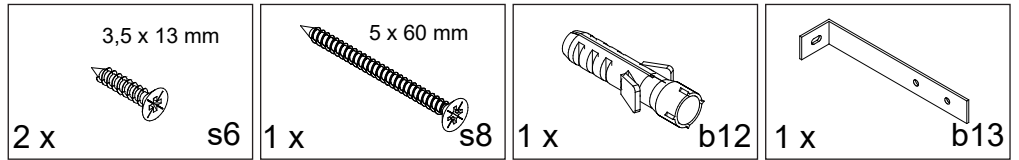

1.

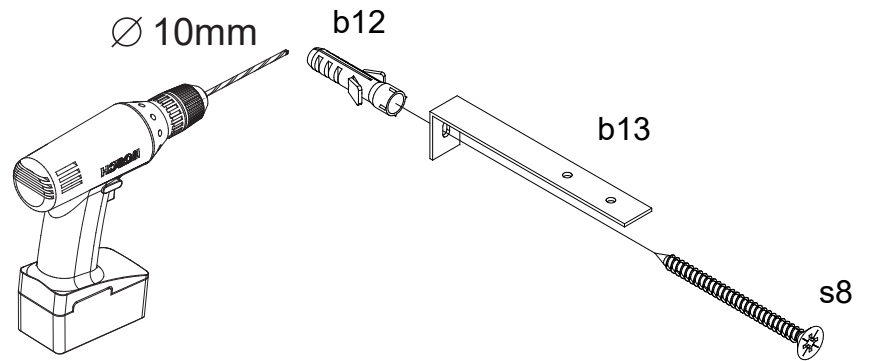

2.

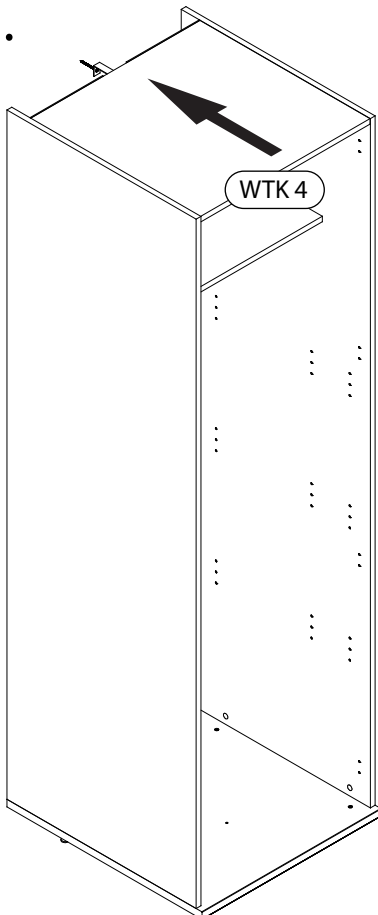

3.

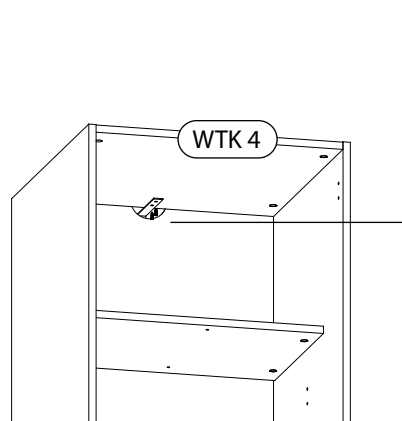
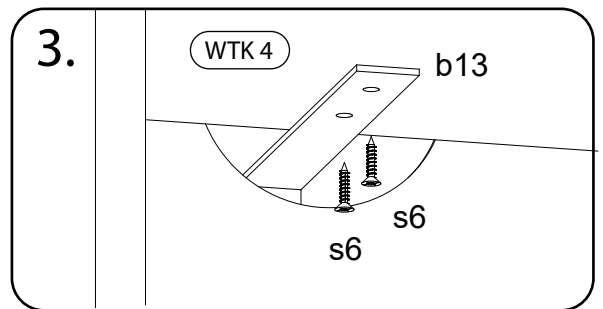

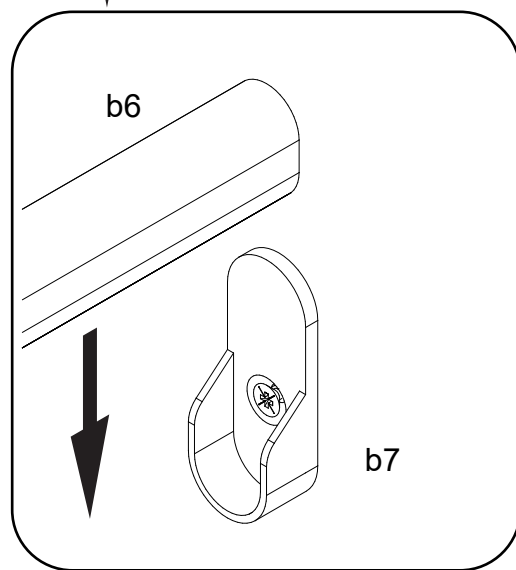
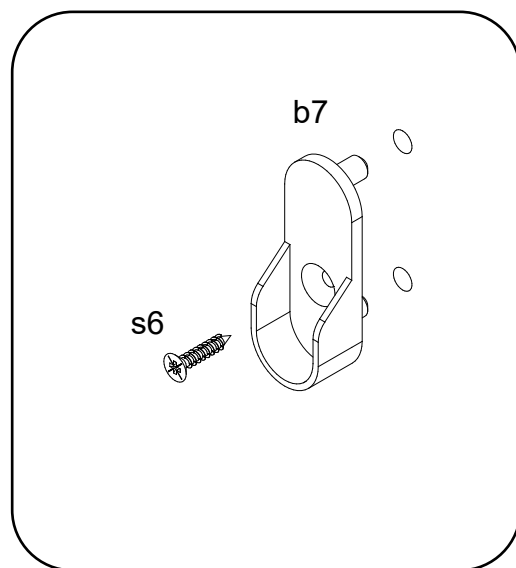
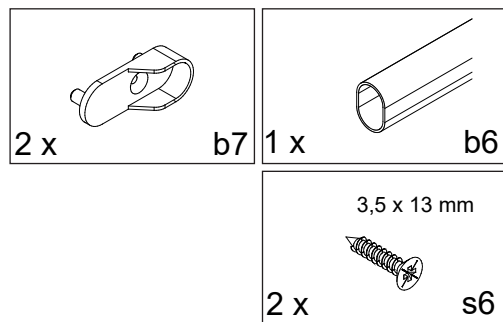
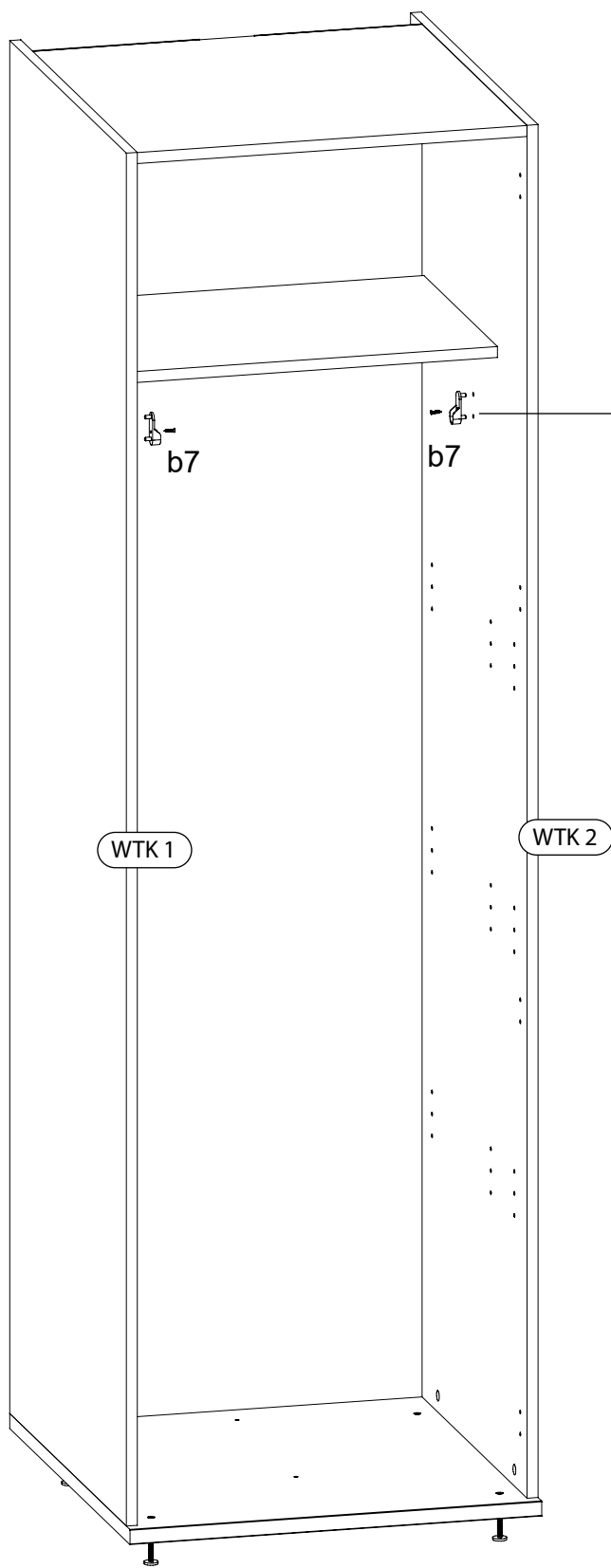

9

