

# TORSTEN SOFA



- (DE) Montageanleitung
- (PL) Instrukcja montażu
- (NL) Handleiding voor de montage
- (GB) Assembly instructions
- (TR) Montaj talimatı
- (RU) Инструкция по монтажу

- (IT) Istruzioni di montaggio
- (FR) Notice de montage
- (RO) Instrucțiuni de asamblare
- (SK) Montážny návod
- (CZ) Montážní návod
- (HU) Szerelési útmutató



Service - Servis - Dienstverlening - Servis - Serwis - Сервисная служба - Servizio - Service  
 Serviciu - Služby - Szolgáltatás



9 x (4x16)  <b>a</b>	4 x (5x35)  <b>b</b>	4 x 25 mm 50mm <b>V</b> 	4 x (M6x60)  <b>c</b>	4 x  <b>f</b>	2x  <b>W</b>
2 x  <b>1</b>	2 x  <b>2</b>				

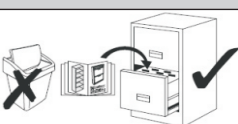
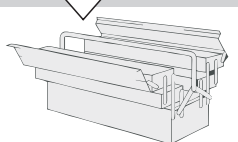
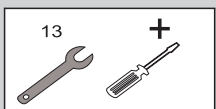
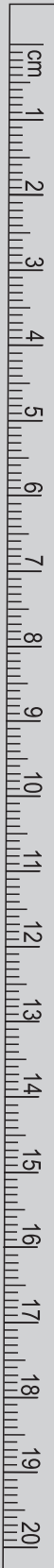
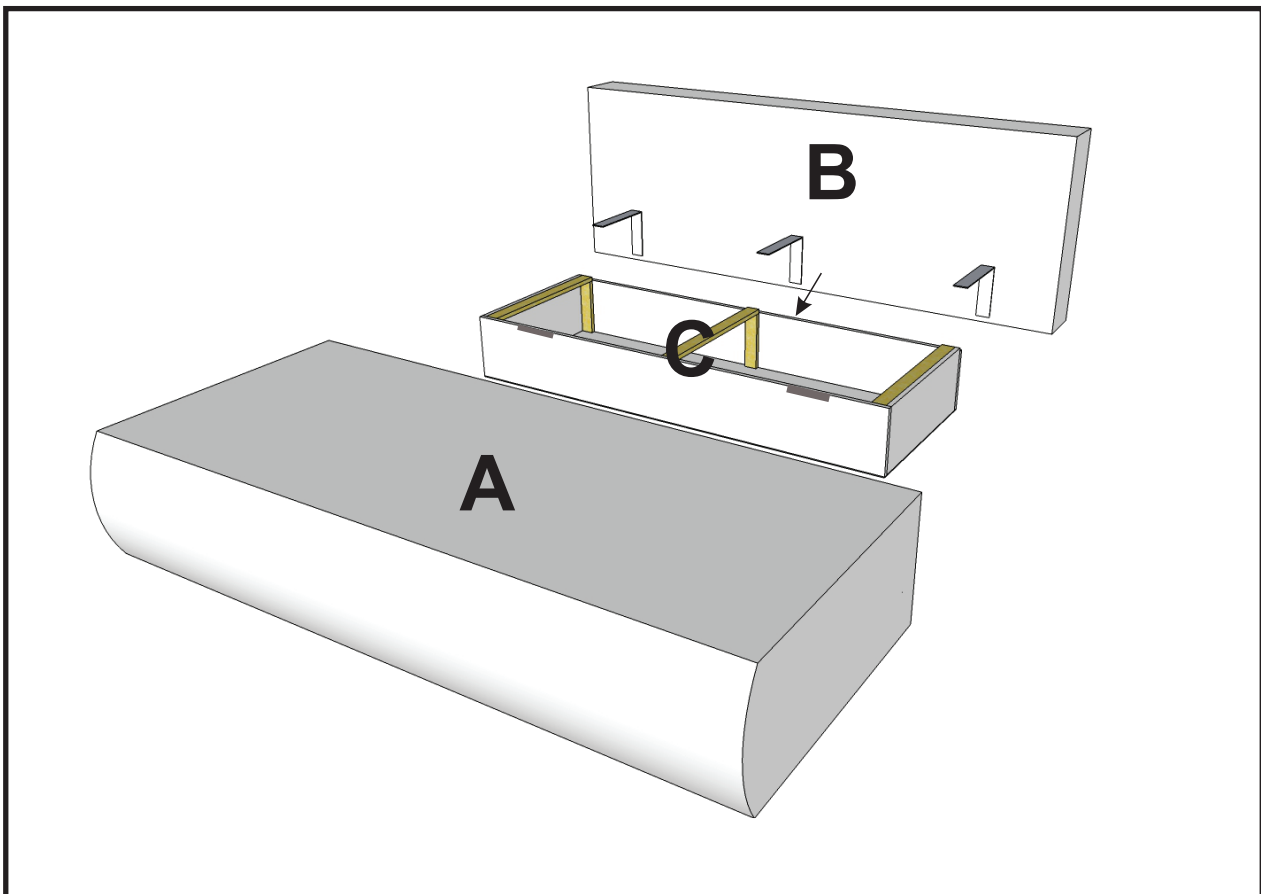

1

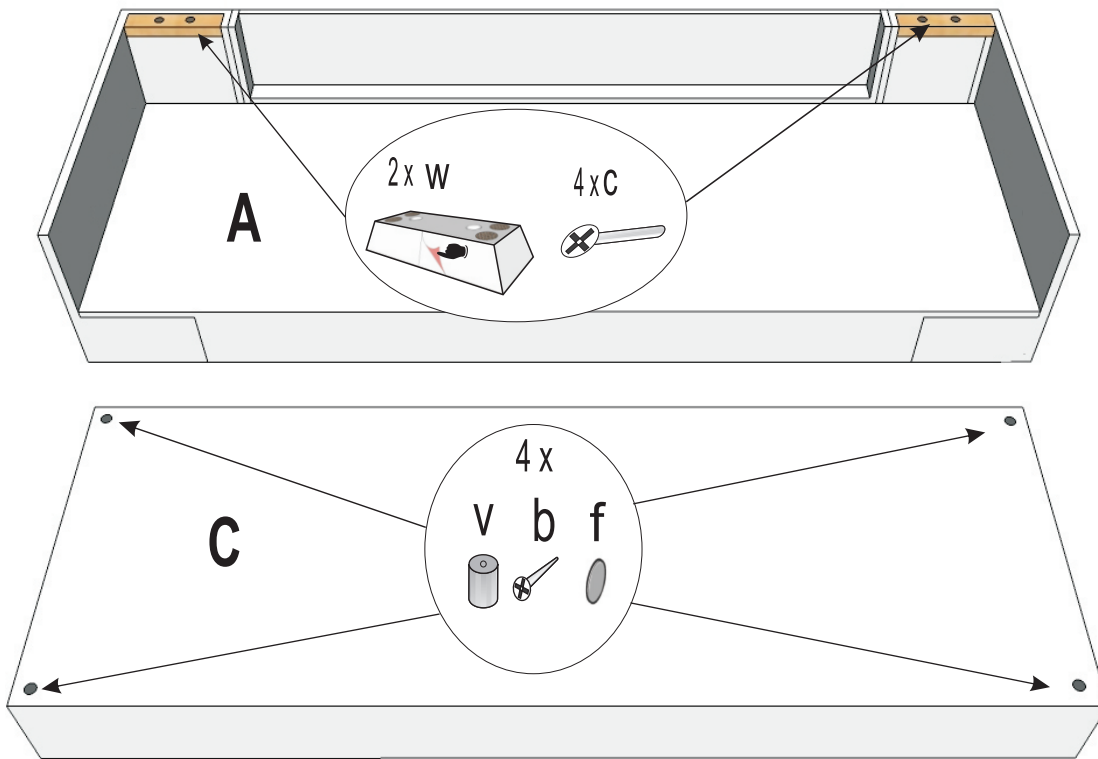

2

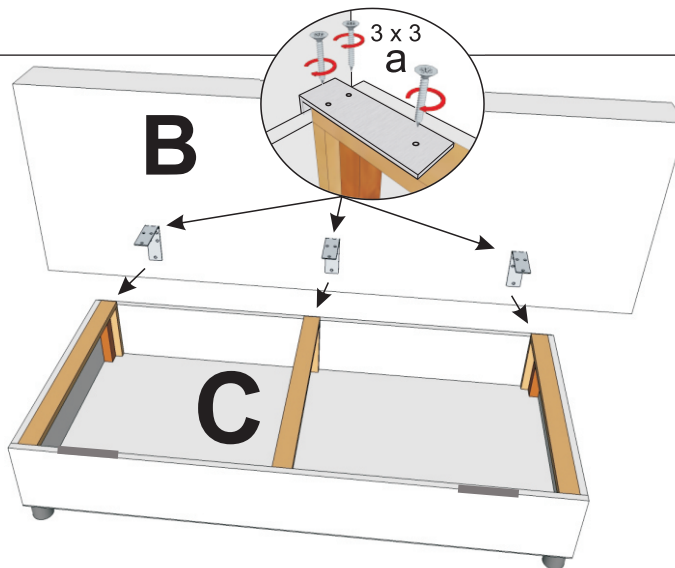

3

